

Office Space for Lease

6502 Grand Teton Plaza, Madison, WI



Corner Office Suite
Quiet, Wooded Setting
Madison West Side

Property features:

- 2104 SF, first floor space.
- Includes 4 private offices, reception, conference room, training room or open work space.
- Suite also includes break area, central work area, IT room.
- Unique building design.
- Building has elevator, atrium, drywall ceilings.

Rent: \$16.50/SF plus utilities

For more information, call
608-827-6867





Suite Interior Photos

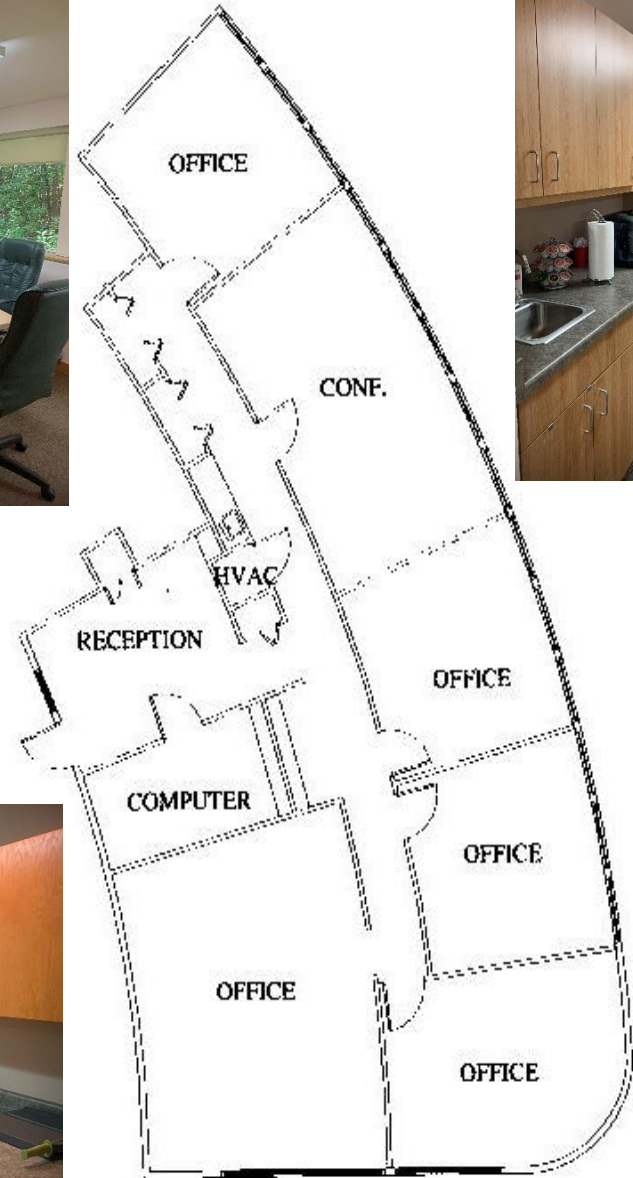

Office Plan

Information was taken from reliable sources - but it is NOT guaranteed accurate. Interested parties are advised to verify all information

BROKER DISCLOSURE TO NON-RESIDENTIAL CUSTOMERS



Property is located in the Park Towne area, just off Mineral Point Road, steps from a Madison Metro bus stop and in close proximity to restaurants, retail stores & services in the vicinity of West Towne regional shopping mall.

- 1 Prior to negotiating on your behalf the Broker must provide you the following disclosure statement:
- 2 **BROKER DISCLOSURE TO CUSTOMERS**
- 3 You are a customer of the broker. The broker is either an agent of another party in the transaction or a subagent of another broker
- 4 who is the agent of another party in the transaction. The broker, or a salesperson acting on behalf of the broker, may provide
- 5 brokerage services to you. Whenever the broker is providing brokerage services to you, the broker owes you, the customer, the
- 6 following duties:
- 7 ■ The duty to provide brokerage services to you fairly and honestly.
- 8 ■ The duty to exercise reasonable skill and care in providing brokerage services to you.
- 9 ■ The duty to provide you with accurate information about market conditions within a reasonable time if you request it, unless
- 10 disclosure of the information is prohibited by law.
- 11 ■ The duty to disclose to you in writing certain material adverse facts about a property, unless disclosure of the information is
- 12 prohibited by law (See Lines 47-55).
- 13 ■ The duty to protect your confidentiality. Unless the law requires it, the broker will not disclose your confidential information or the
- 14 confidential information of other parties (See Lines 22-39).
- 15 ■ The duty to safeguard trust funds and other property the broker holds.
- 16 ■ The duty, when negotiating, to present contract proposals in an objective and unbiased manner and disclose the advantages and
- 17 disadvantages of the proposals.
- 18 Please review this information carefully. A broker or salesperson can answer your questions about brokerage services, but if you
- 19 need legal advice, tax advice, or a professional home inspection, contact an attorney, tax advisor, or home inspector.
- 20 This disclosure is required by section 452.135 of the Wisconsin statutes and is for information only. It is a plain-language summary of
- 21 a broker's duties to a customer under section 452.133 (1) of the Wisconsin statutes.
- 22 **CONFIDENTIALITY NOTICE TO CUSTOMERS**
- 23 BROKER WILL KEEP CONFIDENTIAL ANY INFORMATION GIVEN TO BROKER IN CONFIDENCE, OR ANY INFORMATION
- 24 OBTAINED BY BROKER THAT HE OR SHE KNOWS A REASONABLE PERSON WOULD WANT TO BE KEPT CONFIDENTIAL,
- 25 UNLESS THE INFORMATION MUST BE DISCLOSED BY LAW OR YOU AUTHORIZE THE BROKER TO DISCLOSE PARTICULAR
- 26 INFORMATION. A BROKER SHALL CONTINUE TO KEEP THE INFORMATION CONFIDENTIAL AFTER BROKER IS NO LONGER
- 27 PROVIDING BROKERAGE SERVICES TO YOU.
- 28 THE FOLLOWING INFORMATION IS REQUIRED TO BE DISCLOSED BY LAW:
- 29 1. MATERIAL ADVERSE FACTS, AS DEFINED IN SECTION 452.01 (5g) OF THE WISCONSIN STATUTES (SEE LINES 47-55).
- 30 2. ANY FACTS KNOWN BY THE BROKER THAT CONTRADICT ANY INFORMATION INCLUDED IN A WRITTEN INSPECTION
- 31 REPORT ON THE PROPERTY OR REAL ESTATE THAT IS THE SUBJECT OF THE TRANSACTION.
- 32 TO ENSURE THAT THE BROKER IS AWARE OF WHAT SPECIFIC INFORMATION YOU CONSIDER CONFIDENTIAL, YOU MAY LIST
- 33 THAT INFORMATION BELOW (SEE LINES 35-36). AT A LATER TIME, YOU MAY ALSO PROVIDE THE BROKER WITH OTHER
- 34 INFORMATION YOU CONSIDER TO BE CONFIDENTIAL.
- 35 **CONFIDENTIAL INFORMATION:** _____
- 36 _____
- 37 **NON-CONFIDENTIAL INFORMATION** (The following information may be disclosed by Broker): _____
- 38 _____
- 39 *(INSERT INFORMATION YOU AUTHORIZE THE BROKER TO DISCLOSE SUCH AS FINANCIAL QUALIFICATION INFORMATION.)*
- 40 **CONSENT TO TELEPHONE SOLICITATION**
- 41 I/We agree that the Broker and any affiliated settlement service providers (for example, a mortgage company or title company) may
- 42 call our/my home or cell phone numbers regarding issues, goods and services related to the real estate transaction until I/we
- 43 withdraw this consent in writing. List Home/Cell Numbers: _____
- 44 **SEX OFFENDER REGISTRY**
- 45 Notice: You may obtain information about the sex offender registry and persons registered with the registry by contacting the
- 46 Wisconsin Department of Corrections on the Internet at: <http://offender.doc.state.wi.us/public/> or by phone at 608-240-5830.
- 47 **DEFINITION OF MATERIAL ADVERSE FACTS**
- 48 A "material adverse fact" is defined in Wis. Stat. § 452.01(5g) as an adverse fact that a party indicates is of such significance, or that
- 49 is generally recognized by a competent licensee as being of such significance to a reasonable party, that it affects or would affect
- 50 the party's decision to enter into a contract or agreement concerning a transaction or affects or would affect the party's decision
- 51 about the terms of such a contract or agreement. An "adverse fact" is defined in Wis. Stat. § 452.01(1e) as a condition or occurrence
- 52 that a competent licensee generally recognizes will significantly and adversely affect the value of the property, significantly reduce
- 53 the structural integrity of improvements to real estate, or present a significant health risk to occupants of the property; or information
- 54 that indicates that a party to a transaction is not able to or does not intend to meet his or her obligations under a contract or
- 55 agreement made concerning the transaction.