

	A - 5,700 SF
	B - 7,345 SF
	C - 23,930 SF
	D - 5,720 SF
	E - 6,725 SF
	F - 4,840 SF
	S1 - 620 SF
	S2 - 975 SF
	S3 - 1,410 SF
	S4 - 2,250 SF
	S5 - 8,240 SF
	Circulation - 8,295 SF
<hr/>	
TOTAL - 76,050 SF	

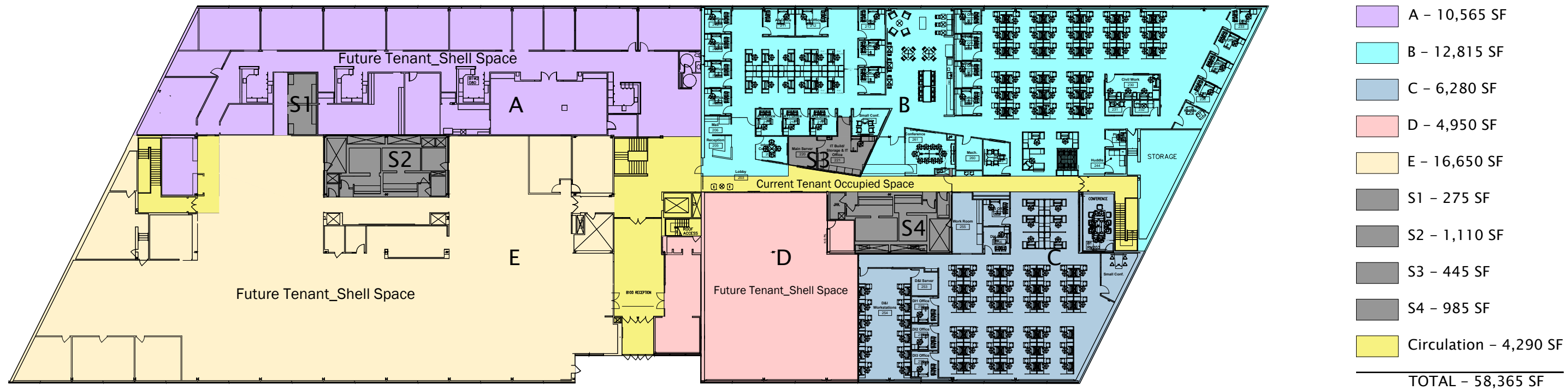

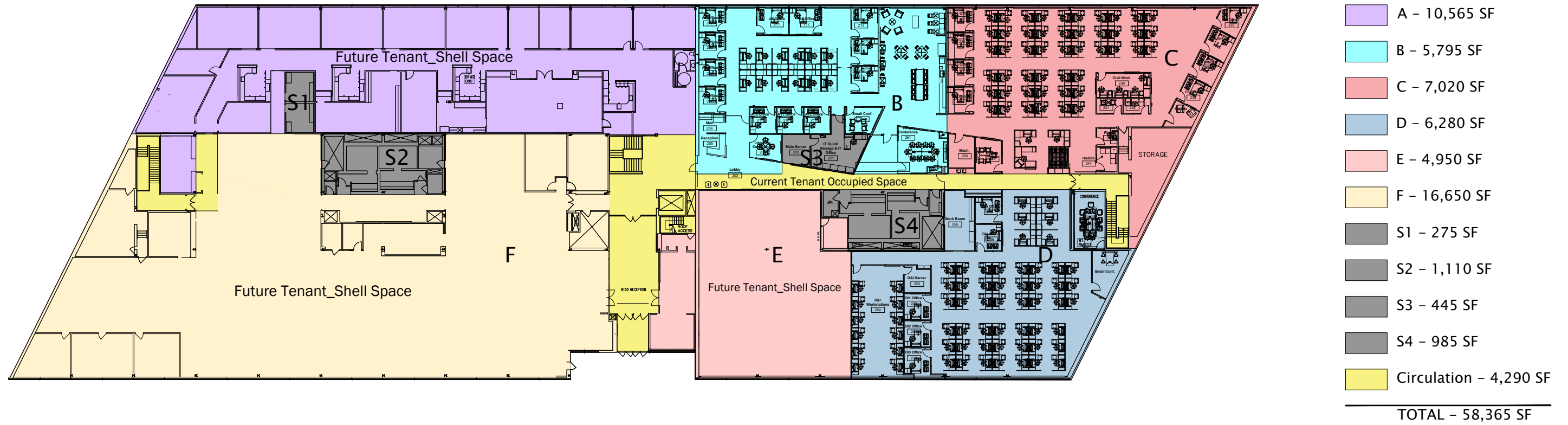

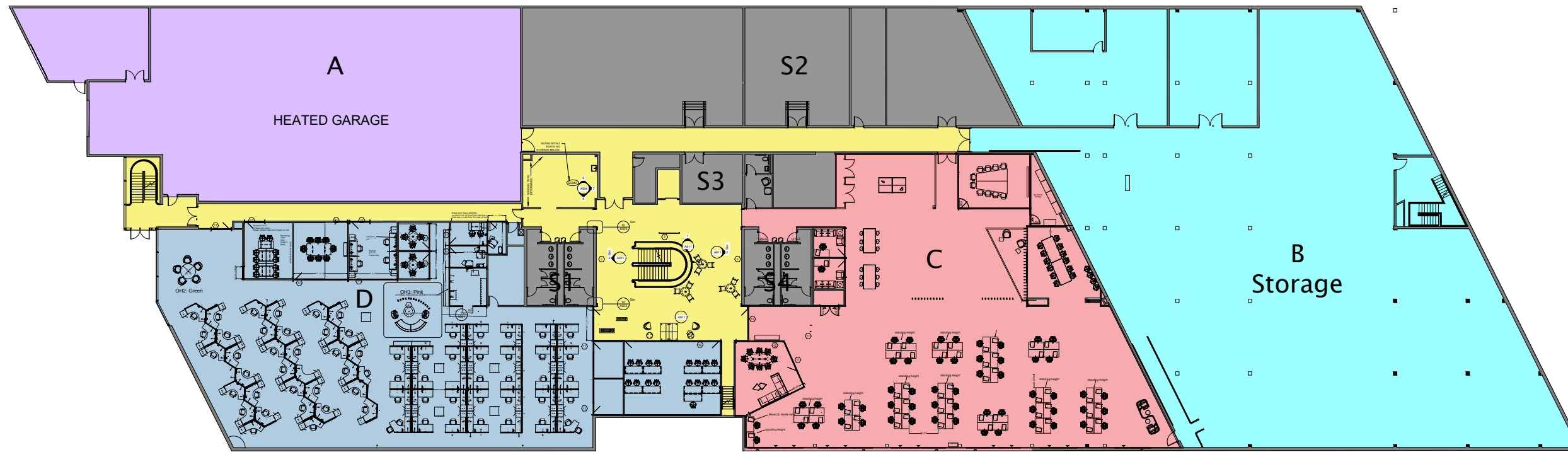

■	A - 9,465 SF
■	B - 19,590 SF
■	C - 10,875 SF
■	D - 10,750 SF
■	S1 - 550 SF
■	S2 - 6,200 SF
■	S3 - 1,120 SF
■	S4 - 550 SF
■	Circulation - 5,560 SF
<hr/>	
	TOTAL - 64,660 SF

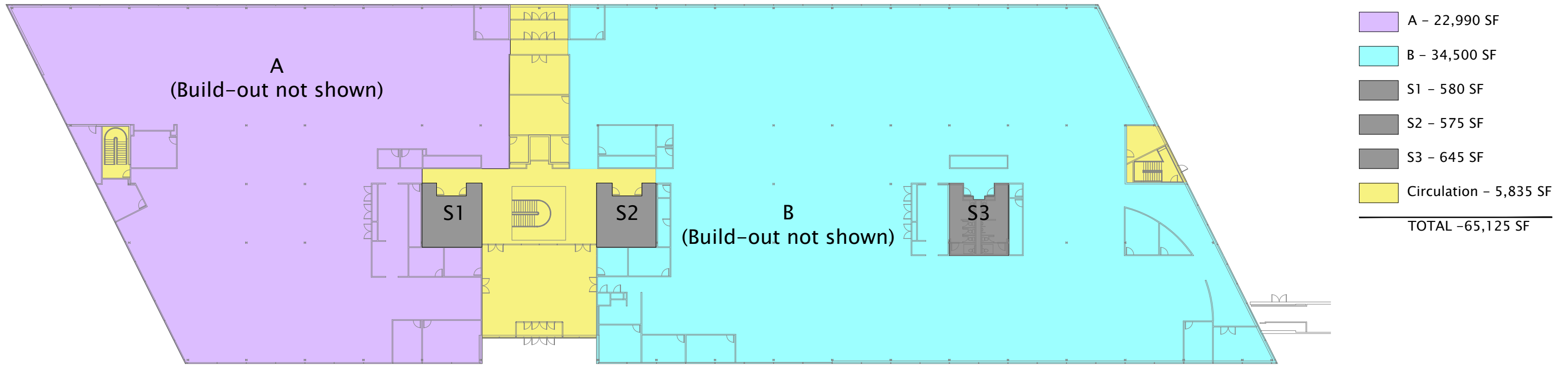

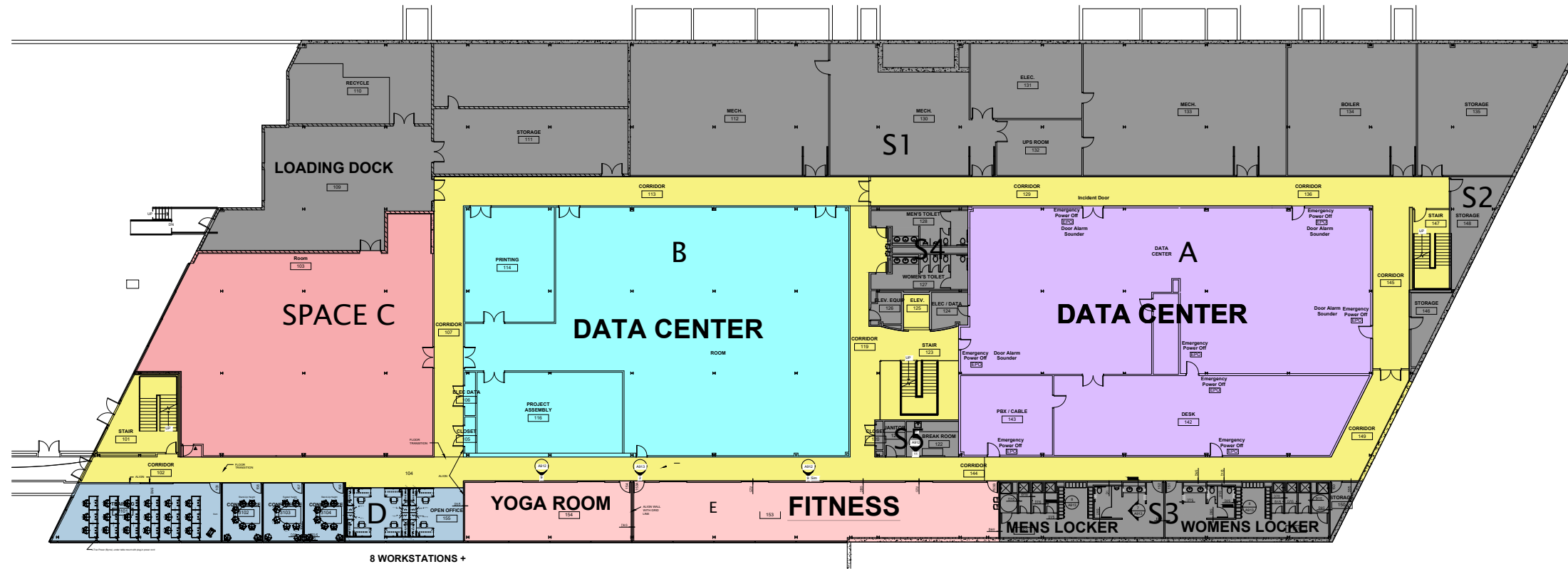

	A - 8,665 SF
	B - 8,320 SF
	C - 4,815 SF
	D - 1,985 SF
	E - 2,795 SF
	S1 - 15,970 SF
	S2 - 570 SF
	S3 - 1,815 SF
	S4 - 890 SF
	S5 - 265 SF
	Circulation - 8,745 SF
<hr/>	
	TOTAL - 54,835 SF



JLA
ARCHITECTS

DERBY DISTRICT- SQUARE FOOTAGE DIAGRAMS

BUILDING 300 - FIRST FLOOR

JANUARY 14, 2026
1"=40' @ 11x17

100-Person
Training Room

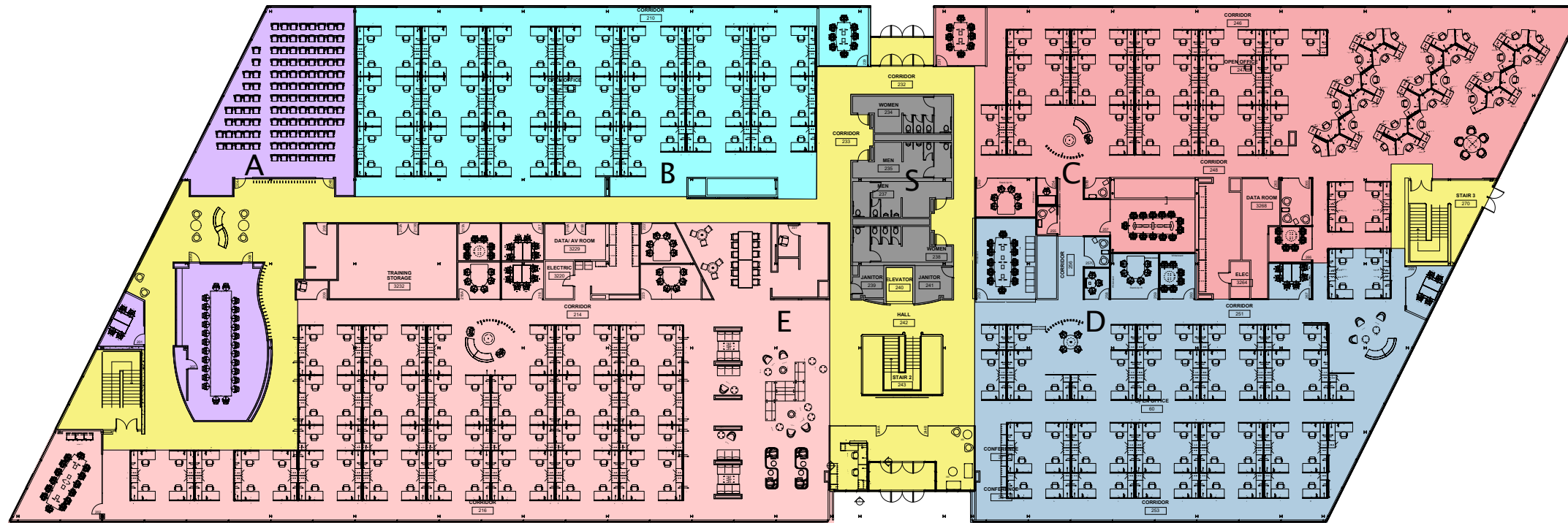

	A - 4,505 SF
	B - 7,485 SF
	C - 10,670 SF
	D - 9,135 SF
	E - 14,630 SF
	S - 1,515 SF
	Circulation - 6,965 SF
<hr/>	
	TOTAL - 54,900 SF