



BIOMANUFACTURING FACILITY  
FOR LEASE  
41,000 SF



535  
SCIENCE  
DRIVE

MADISON, WISCONSIN

# BIOMANUFACTURING FACILITY

AVAILABLE IMMEDIATELY

This 41,000-square-foot GMP-compliant biomanufacturing facility offers a turnkey solution for life sciences companies seeking high-performance infrastructure in a strategic location. Designed to meet rigorous regulatory standards, the facility features five ISO-7 cleanrooms totaling 6,000 square feet, equipped with airlocks, differential pressure sensors, epoxy finishes, and advanced HVAC systems with MERV 14 and HEPA filtration delivering 30-40 air changes per hour. ISO-8 spaces are similarly supported with 20 ACH, ensuring optimal environmental control for sensitive processes.

In addition to cleanroom capabilities, the facility includes BSL-2 and QC laboratories within the cleanroom boundary, offering clean air, robust power capacity, and proximity to EM and specialty labs. Office and amenity spaces are modern and thoughtfully designed, including conference rooms, reception areas, and support zones that enhance operational efficiency and employee comfort. Validated cold storage is a standout feature, with three mapped 2-8°C cold rooms supported by redundant systems to ensure product integrity.

The shipping and receiving infrastructure is equally robust, featuring temperature-controlled dual docks, secure material flow pathways, and a high-bay warehouse with both ambient and cold storage capabilities.

A TURNKEY SOLUTION  
FOR LIFE SCIENCES



# BUILDING DETAILS

41,000 SF GMP-COMPLIANT FACILITY

## Cleanroom

Five ISO-7 processing rooms totaling 6,000 SF with airlocks, differential pressure sensors, epoxy finishes, redundant HVAC, and MERV 14 + HEPA filtration at 30-40 ACH, 20ACH for ISO8 spaces

## Laboratories

BSL-2 and QC lab in cleanroom boundary with casework, clean air, high power capacity, and nearby EM/specialty labs

## Office & Amenities

Modern office, conference, reception, and support areas

## Validated Cold Storage

Three mapped 2-8°C cold rooms with redundant systems

## Shipping/Receiving

Temperature-controlled dual docks, secure material flow, High bay warehouse (ambient) and 2-8°C

## IDEAL USE CASES



CELL & GENE THERAPY



BIOLOGICS AND ADVANCED THERAPEUTICS



REGENERATIVE MEDICINE



VACCINE OR TISSUE-BASED MANUFACTURING



CDMOs SEEKING TURNKEY GMP INFRASTRUCTURE



CLEAN ROOM AUTOCLAVE



QUALITY CONTROL LAB

# BUILDING SYSTEMS

HIGH-PERFORMANCE INFRASTRUCTURE



## POWER

1,600A, 480Y/277V 3-phase 4-wire service with dual utility feeds and three natural gas backup generators

## HVAC

Redundant AHUs, chilled glycol, and heating hot water/glycol systems serve cleanrooms and labs, heat recovery with run around

## CLEAN STEAM

1,750 lb/hr at 45 psig for humidification and autoclaves

## PURIFIED WATER

USP-purified grade, 4 GPM production with 30 GPM distribution

## COMPRESSED AIR

Redundant, dry, oil-free air at -40°F dewpoint

## LN2 DISTRIBUTION

Vacuum-jacketed piping to two areas piped to external bulk tank pad

## PROCESS VACUUM

Centralized, sized for 9 scfm at 19" HG

## FIRE PROTECTION

75HP electric fire pump, wet sprinkler systems, and FK-5-1-12 clean agent system in select areas

## IT & SECURITY

Structured Cat6 cabling, access control, intrusion detection, and full video surveillance



# FLOOR PLAN

41,000 SF

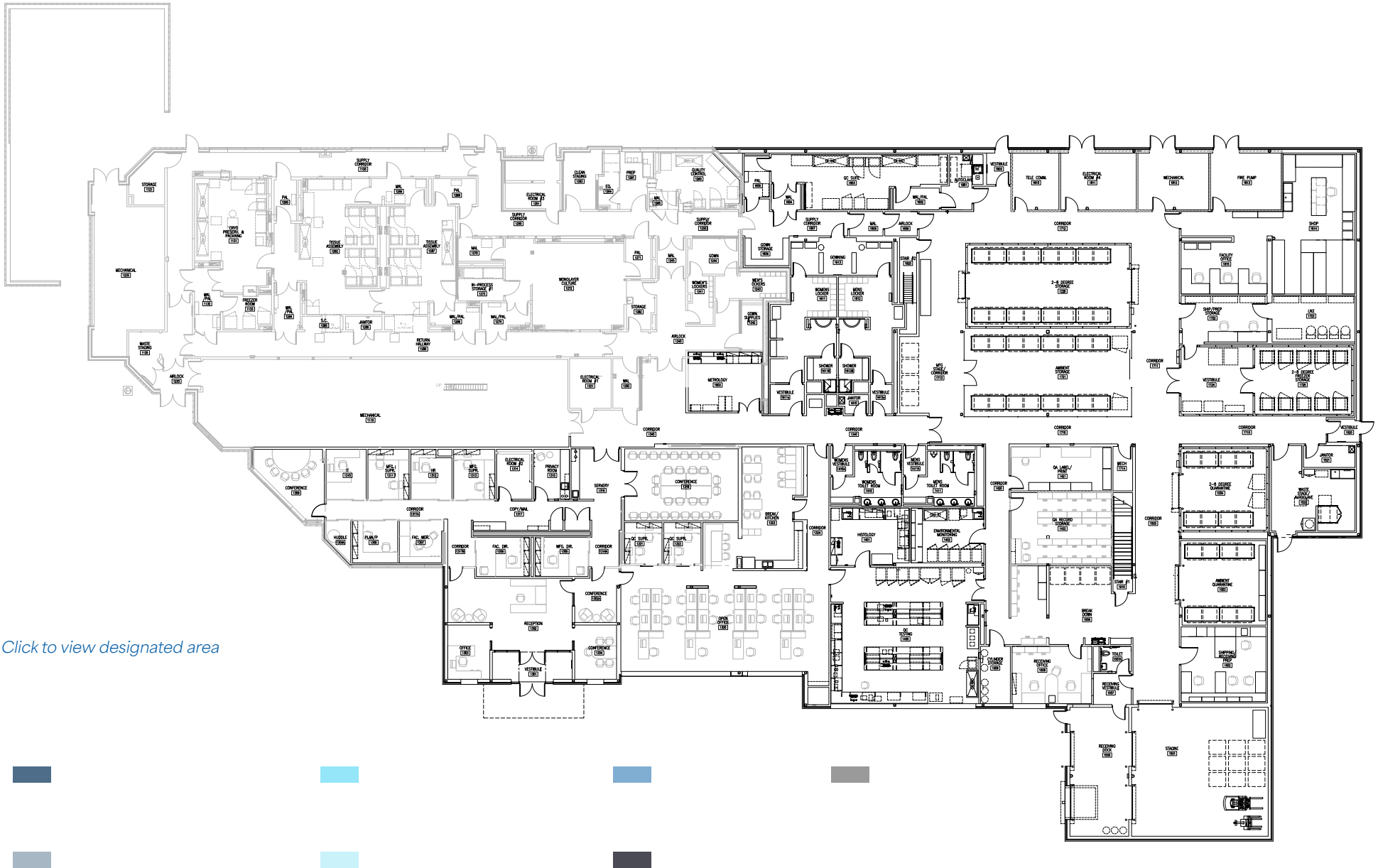

# FLOOR PLAN

## ISO - CONTROLLED AREAS

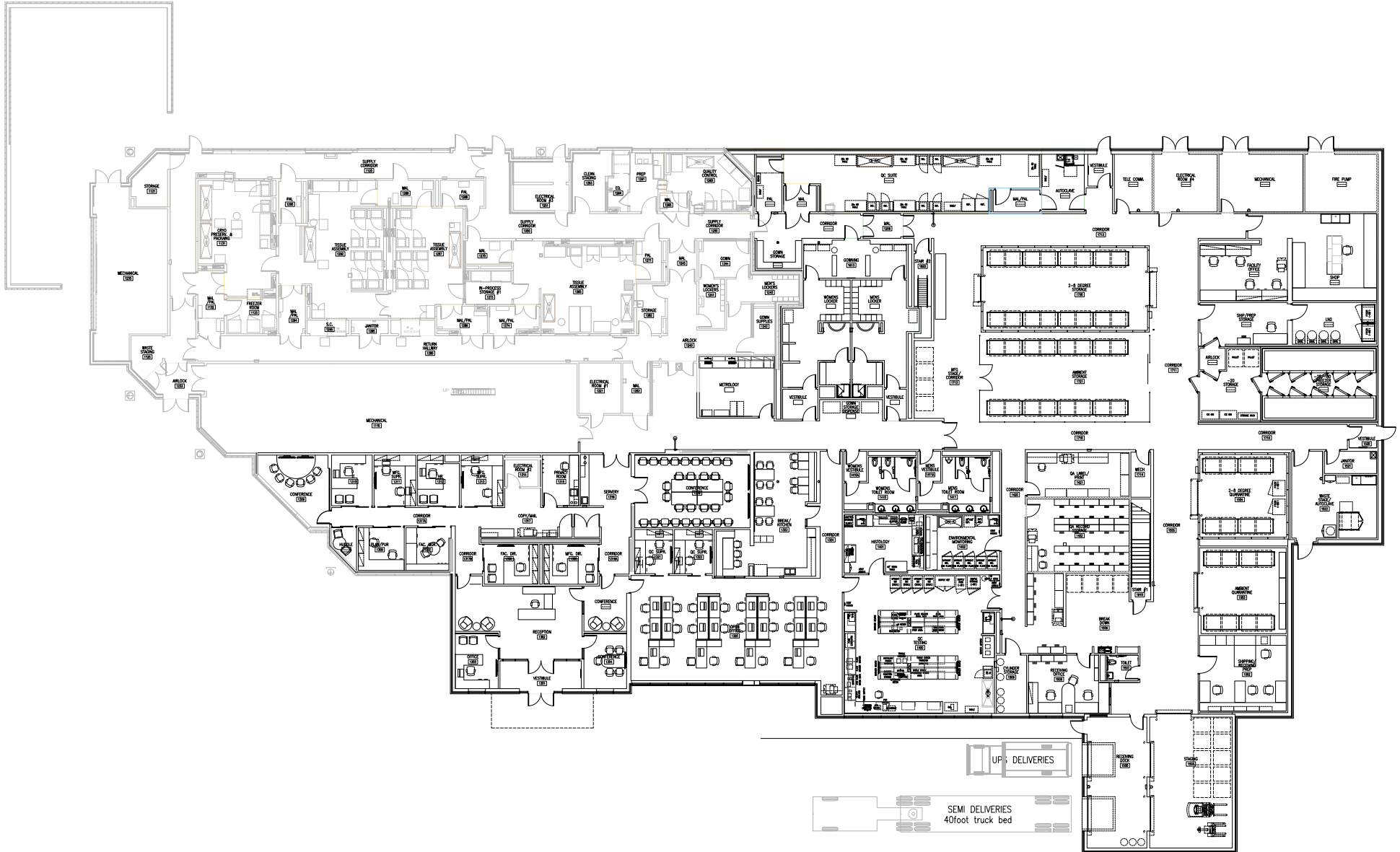

# UNIVERSITY RESEARCH PARK

## INNOVATION IN ACTION

Established in 1984, University Research Park (URP) is a nationally recognized technology and research hub affiliated with UW-Madison. It supports over 9,300 jobs statewide and contributes more than \$825 million annually to Wisconsin's economy<sup>4</sup>.

URP is home to a vibrant ecosystem of startups and established firms in biotechnology, engineering, and computational sciences. Companies like Stratatech, Cellular Dynamics, and Nimble Therapeutics have grown from UW research into industry leaders, leveraging URP's specialized infrastructure, incubators like Forward BioLabs, and a community of over 4,100 knowledge workers<sup>5</sup>.

The park exemplifies how academic innovation translates into commercial success, making Madison a magnet for investment and talent.

**\$825M**

CONTRIBUTION TO WISCONSIN'S  
ECONOMY EACH YEAR

**9,300**

JOBS SUPPORTED STATEWIDE

**\$43M**

STATE AND LOCAL TAX REVENUE  
GENERATED EVERY YEAR

Sources

[4] UW-Madison Admissions Guide 2025-2026 - vappingo.com

[5] College of Agricultural and Life Sciences < University of Wisconsin-Madison

535 SCIENCE DRIVE

An aerial photograph of the University Research Park in Madison, Wisconsin. The image shows a large complex of modern research buildings, parking lots, and green spaces. A teal callout box with a white arrow points to a specific building complex, labeled "535 SCIENCE DRIVE". The surrounding area includes roads, trees, and a glimpse of a lake in the distance under a clear blue sky.

# UNIVERSITY RESEARCH PARK

MADISON, WISCONSIN



UW-Madison Labs

Invenra

Element Labs

Exact Sciences

Ultratec

Arrowhead Pharmaceuticals

WiCell Research Institute

Exact Sciences

FUJIFILM Cellular Dynamics

Affiliated Engineers, Inc.

MGE Innovation Center

Flad Architects

Illumina

Mirus Bio

Aldevron Madison

Millipore Sigma

535 Science Drive

PCI Pharma Services

Millipore Sigma

Influenza Research Institute

Advanced Assembly

UW HEALTH Behavior Health Clinic

UW HEALTH Science Dr Medical Center

Millipore Sigma

AbbVie





# MADISON, WISCONSIN

Madison, WI stands out as a thriving economic and cultural center in the Midwest. Anchored by five key industries—advanced manufacturing, healthcare, agriculture and food production, information technology, and biosciences—the region supports over 500,000 residents and thousands of businesses<sup>1</sup>. Major employers include Epic Systems, UW Health, American Family Insurance, and the University of Wisconsin-Madison, which alone contributes over \$30.8 billion annually to the state economy and supports more than 232,000 jobs<sup>2</sup>.

The city boasts a remarkably low unemployment rate of 2.7% as of June 2025<sup>3</sup>, and a median household income of \$76,983<sup>4</sup>, reflecting a stable and prosperous labor market. Madison's business-friendly climate is further enhanced by ongoing infrastructure investments and a highly educated workforce.

Beyond its economic vitality, Madison offers an exceptional quality of life. The city is renowned for its walkable downtown, vibrant arts scene, and diverse culinary offerings. Cultural landmarks like the Madison Museum of Contemporary Art and Frank Lloyd Wright's Taliesin enrich the urban experience<sup>5</sup>. The University of Wisconsin-Madison not only drives innovation but also infuses the city with youthful energy, academic excellence, and global connectivity.

## Sources

- [1] University of Wisconsin-Madison - Wikipedia
- [2] Degrees & Programs - University of Wisconsin-Madison
- [3] What are the popular degrees offered at UW Madison?
- [4] Majors and Certificates - Agricultural & Life Sciences
- [5] Engineering Majors at UW-Madison

ECONOMIC AND  
CULTURAL CENTER

# UNIVERSITY OF WISCONSIN-MADISON

INNOVATION AND TALENT HUB

## RESEARCH POWERHOUSE

UW-Madison ranks 6th nationally in research expenditures among U.S. universities, with over \$1.7 billion in annual research spending<sup>1</sup>. Nearly half of this funding comes from federal sources such as the NIH, NSF, and Department of Defense<sup>1</sup>.

# #2

U.S. PUBLIC UNIVERSITY

According to Time magazine's *World's Top Universities of 2026*

## INDUSTRY ENGAGEMENT

UW-Madison partners with over 3,000 Wisconsin businesses and organizations annually, contributing more than \$360 million in local economic activity through goods, services, and grants<sup>3</sup>.

## BIOTECH INNOVATION

The university has produced 500+ patented medical devices, imaging tools, and pharmaceutical technologies, supported by the Wisconsin Alumni Research Foundation (WARF)<sup>5</sup>.

## FACULTY EXCELLENCE

The School of Medicine and Public Health alone accounts for 37% of all research grants awarded to UW-Madison, with \$526 million in research expenditures<sup>5</sup>.

## STUDENT BODY

UW-Madison enrolls approximately 39,000 undergraduate students, with a student-to-faculty ratio of 18:1 and a retention rate of 96.1%<sup>6</sup>



Madison, Wisconsin, is a vibrant center for innovation, anchored by the University of Wisconsin-Madison—one of the nation's top research universities. Each year, UW-Madison graduates over 8,000 students<sup>1</sup>, including more than 1,500 in high-demand STEM fields such as biology, chemistry, biomedical and chemical engineering, and biotechnology<sup>2,3</sup>.

With undergraduates completing degrees in an average of just 3.84 years, the university delivers a steady pipeline of highly skilled professionals to support the region's thriving biotech and healthcare sectors.

Sources:

[1] The Daily Cardinal  
[2] UW-Madison  
[3] UW-Madison

[4] UW-Madison  
[5] School of Medicine  
[6] UW-Madison

# MADISON, WISCONSIN

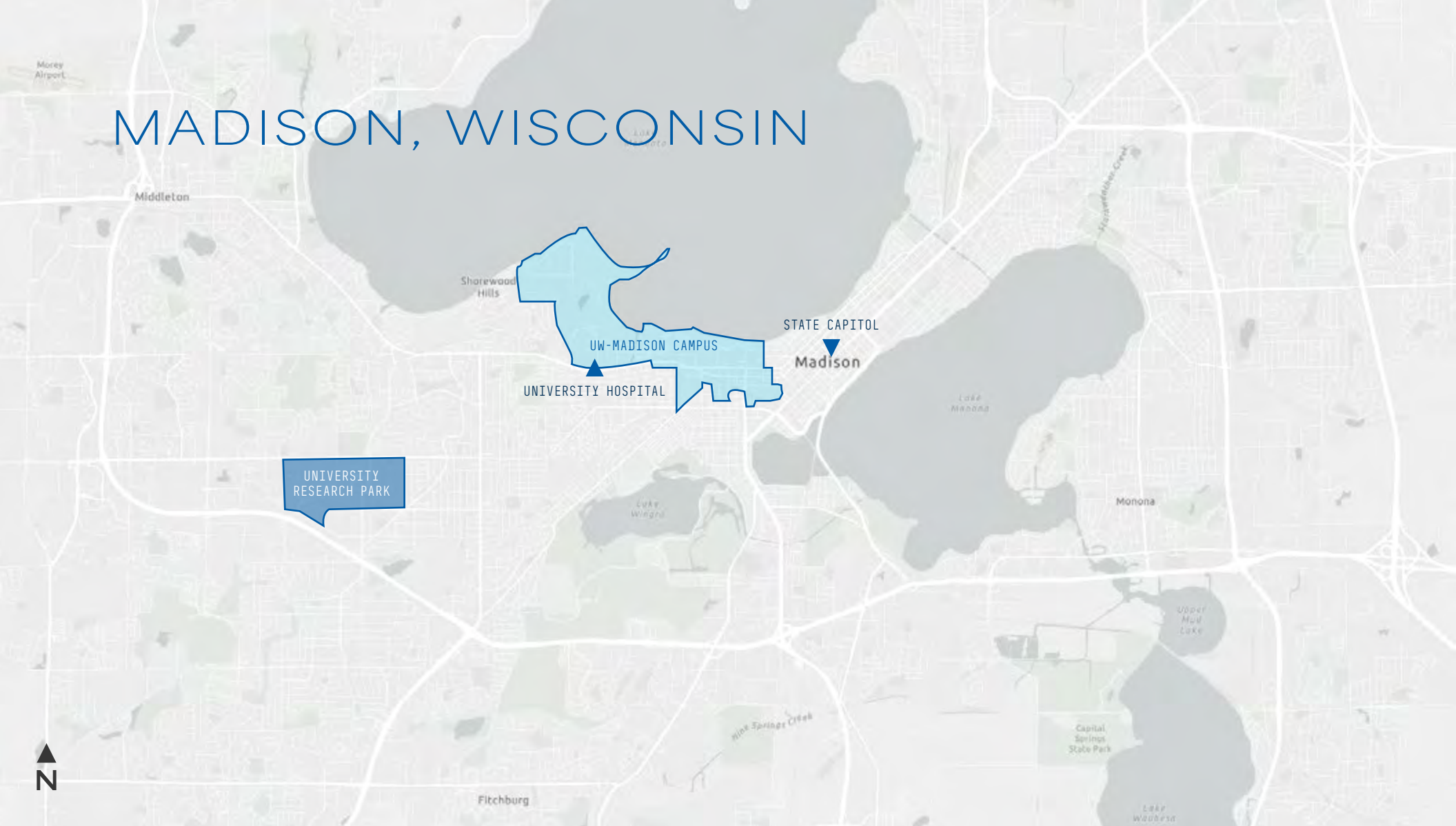

**237K**

RESIDENTS IN THE CITY OF MADISON

**31.1**

MEDIUM AGE

**\$97K**

MEAN HOUSEHOLD INCOME

**55%**

OF ADULTS (25+) HOLD A BACHELOR'S DEGREE OR HIGHER



[1]



[2]



[3]



[4]



[5]

## A TURNKEY SOLUTION FOR LIFE SCIENCES

- [1] Office Corridor
- [2] Loading Dock
- [3] Mechanical Room
- [4] Office Area
- [5] Corridor



BIOMANUFACTURING FACILITY  
41,000 SF

# 535 SCIENCE DRIVE

MADISON, WISCONSIN

**CHASE BRIEMAN**

Senior Vice President

+1 608 441 7571

[chase.brieman@cbre.com](mailto:chase.brieman@cbre.com)

**JAMES WEST**

Vice President

+1 608 441 7578

[j.west@cbre.com](mailto:j.west@cbre.com)



© 2026 CBRE, Inc. All rights reserved. This information has been obtained from sources believed reliable but has not been verified for accuracy or completeness. CBRE, Inc. makes no guarantee, representation or warranty and accepts no responsibility or liability as to the accuracy, completeness, or reliability of the information contained herein. You should conduct a careful, independent investigation of the property and verify all information. Any reliance on this information is solely at your own risk. CBRE and the CBRE logo are service marks of CBRE, Inc. All other marks displayed on this document are the property of their respective owners, and the use of such marks does not imply any affiliation with or endorsement of CBRE. Photos herein are the property of their respective owners. Use of these images without the express written consent of the owner is prohibited.

# State of Wisconsin Broker Disclosure To Non-Residential Customers



Wisconsin Law requires all real estate licensees to give the following information about brokerage services to prospective customers.

---

Prior to negotiating on your behalf the Broker must provide you the following disclosure statement:

## Broker Disclosure to Customers

You are the customer of the broker. The broker is either an agent of another party in the transaction or a subagent of another broker who is the agent of another party in the transaction. The broker, or a salesperson acting on the behalf of the broker, may provide brokerage services to you. Whenever the broker is providing brokerage services to you, the broker owes you, the customer the following duties:

- The duty to prove brokerage services to you fairly and honestly.
- The duty to exercise reasonable skill and care in providing brokerage services to you.
- The duty to provide you with accurate information about market conditions within a reasonable time if you request it, unless disclosure of the information is prohibited by law.
- The duty to disclose to you in writing certain material adverse facts about a property, unless disclosure of the information is prohibited by law (see “Definition of Material Adverse Facts” below).
- The duty to protect your confidentiality. Unless the law requires it, the broker will not disclose your confidential information of other parties.
- The duty to safeguard trust funds and other property the broker holds.
- The duty, when negotiating, to present contract proposals in an objective & unbiased manner and disclose the advantages and disadvantages of the proposals.

Please review this information carefully. A broker or salesperson can answer your questions about brokerage services, but if you need legal advice, tax advice, or a professional home inspection, contact an attorney, tax advisor, or home inspector. This disclosure is required by section 452.135 of the Wisconsin Statutes and is for information only. It is a plain language summary of a broker’s duties to a customer under section 452.133(l) of the Wisconsin Statutes.

## Confidentiality Notice to Customers

Broker will keep confidential any information given to broker in confidence, or any information obtained by broker that he or she knows a reasonable person would want to be kept confidential by law, or authorize the broker to disclose particular information. A broker shall continue to keep the information confidential after broker is no longer providing brokerage services to you.

The following information is required to be disclosed by law.

1. Material adverse facts, as defined in section 452.01(5g) of the Wisconsin statutes (see “definition of material adverse facts” below).
2. Any facts known by the broker that contradict any information included in a written inspection report on the property or real estate that is the subject of the transaction. To ensure that the broker is aware of what specific information below. At a later time, you may also provide the broker with other information that you consider to be confidential.

CONFIDENTIAL INFORMATION: \_\_\_\_\_

NON-CONFIDENTIAL INFORMATION (The following information may be disclosed by Broker): \_\_\_\_\_

(Insert information you authorize to broker to disclose such as financial qualification information)

## Consent to Telephone Solicitation

I/We agree that the Broker and any affiliated settlement service providers (for example, a mortgage company or title company) may call our/my home or cell phone numbers regarding issues, goods and services related to the real estate transaction until I/ we withdraw this consent in writing. List Home/Cell Numbers: \_\_\_\_\_

## Sex Offender Registry

*Notice: You may obtain information about the sex offender registry and persons registered with the registry by contacting the Wisconsin Department of Corrections on the Internet at <http://offender.doc.state.wi.us/public/> or by phone at (608)240-5830.<http://offender.doc.state.wi.us/public/> or by phone at (608) 240-5830.*

## Definition of Material Adverse Facts

A “material adverse fact” is defined in Wis. Stat. 452.01 (5g) as an adverse fact that a party indicates is of such significance, or that is generally recognized by a competent licensee as being of such significance to a reasonable party that it affects or would affect the party’s decision to enter into a contract or agreement concerning a transaction or affects or would affect the party’s decision about the terms of such a contract or agreement. An “adverse fact” is defined in Wis. Stat. 452.01 (1e) as a condition or occurrence that a competent licensee generally recognizes will significantly adversely affect the value of the property, significantly reduce the structural integrity of improvements to real estate, or present a significant health risk to occupants of the property, or information that indicates that a party to a transaction is not able to or does not intend to meet his or her obligations under a contract or agreement made concerning the transaction.

*No representation is made as to the legal validity of any provision or the adequacy of any provision on any specific transaction.*