

SUITE 304 - 761 SF

SUITE 320 - 770 SF

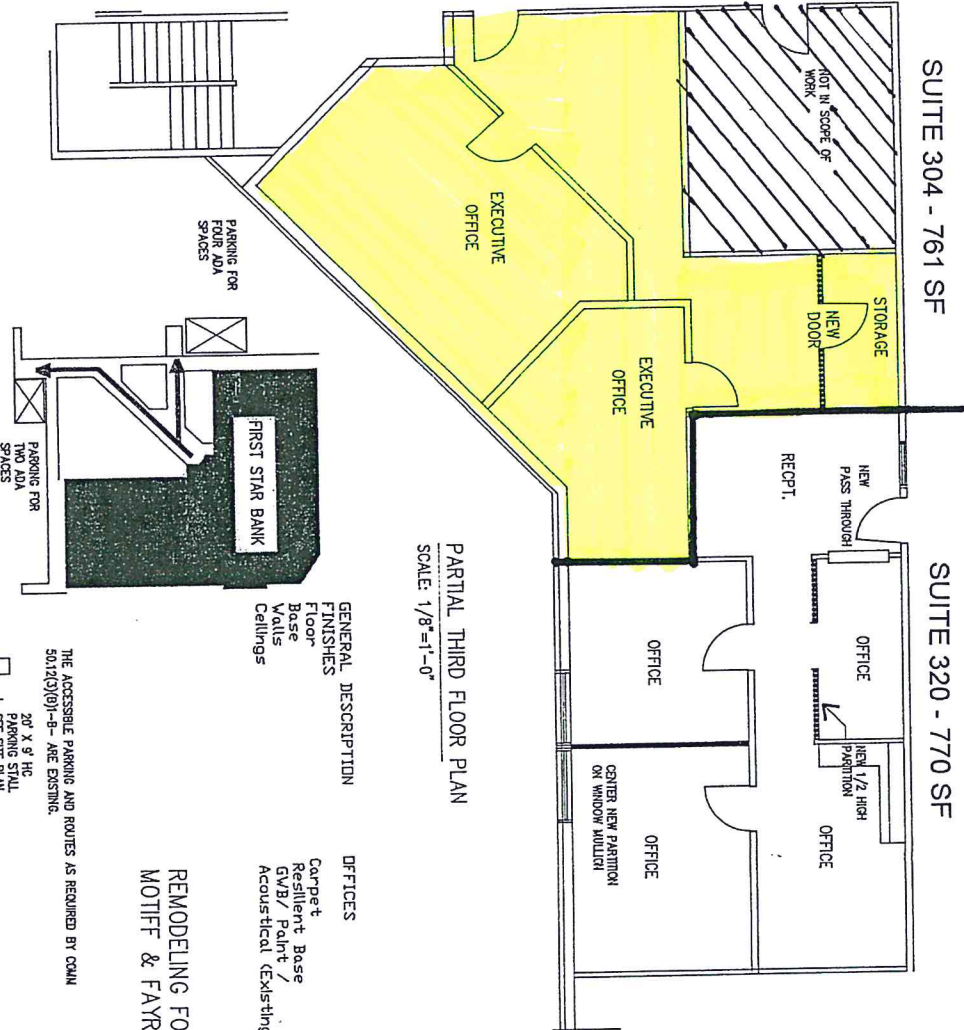

PARTIAL THIRD FLOOR PLAN
SCALE: 1/8"=1'-0"

GENERAL DESCRIPTION
FINISHES
Floor
Base
Walls
Ceilings

OFFICES
Carpet
Resilient Base
GWB/ Paint /
Acoustical (Existing)

GENERAL DESCRIPTION
FINISHES
Floor
Base
Walls
Ceilings

STORAGE
Carpet
Resilient Base
GWB/ Paint /
Acoustical (Existing)

REMODELING FOR SPACE 304 FOR
MOTIFF & FAYRAM, LTD.

THE ACCESSIBLE PARKING AND ROUTES AS REQUIRED BY CCAM
5012(C)(9)-9- ARE EXISTING.

20' X 8' HC
PARKING STALL
SEE SITE PLAN
FOR LOCATION

SITE PLAN
SCALE: NONE

- GENERAL NOTES
1. REPAIR WALLS WHERE CLOSETS ARE REMOVED. SEE SHEET 1 FOR DETAIL.
 2. NEW WALLS - SEE DETAILS.
 3. EXISTING LIGHTING TO REMAIN. MOORE SWITCHING AS REQUIRED.
 4. NEW DOORS TO BE 3' - 0" X 6' - 6", 1 3/4" THICK, SOLID CORE, OAK.
 5. NEW PASS THROUGH AT RECEPTION AREA TO BE 6' X 3' HIGH AND 3' - 6" OFF FLOOR. MATCH DOOR HEIGHT.

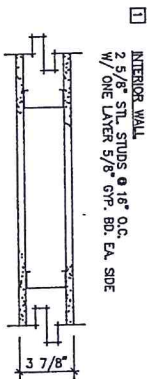

OFFICE SPACE
FIRST STAR BANK BUILDING
402 GAMMON PLACE, MADISON, WI
OCTOBER 21, 2001

SHEET NUM.

2

