



For Lease

5001 World Dairy Drive Madison, WI 53718

Move-In Ready Lab Building Available

Building Size	8,704 SF
Parking	Aprox. 27 stalls
OpEx	TBD
Lease Rate	\$13.00 PSF NNN

- Full building, single-story lab space.
- Substantial plumbing and benches for a move-in ready set up.
- Reception, private offices, large break room and conference room.
- Lab area has a mixture of open workspace and private work areas.
- Overhead door.
- Ample parking
- Great location with close proximity to the Beltline & Interstate

Contact Us

Chris Richards

Partner

+1 608 628 5895

chris.richards@colliers.com

Colin McLandsborough

Real Estate Advisor

+1 262 309 5597

colin.mclandsborough@colliers.com

Dustin Pate

Senior Real Estate Advisor

+1 608 867 7471

dustin.pate@colliers.com

Colliers | Wisconsin

316 W Washington Ave, suite 925

Madison, WI 53703

P: +1 608 826 9500

colliers.com

Floor Plan

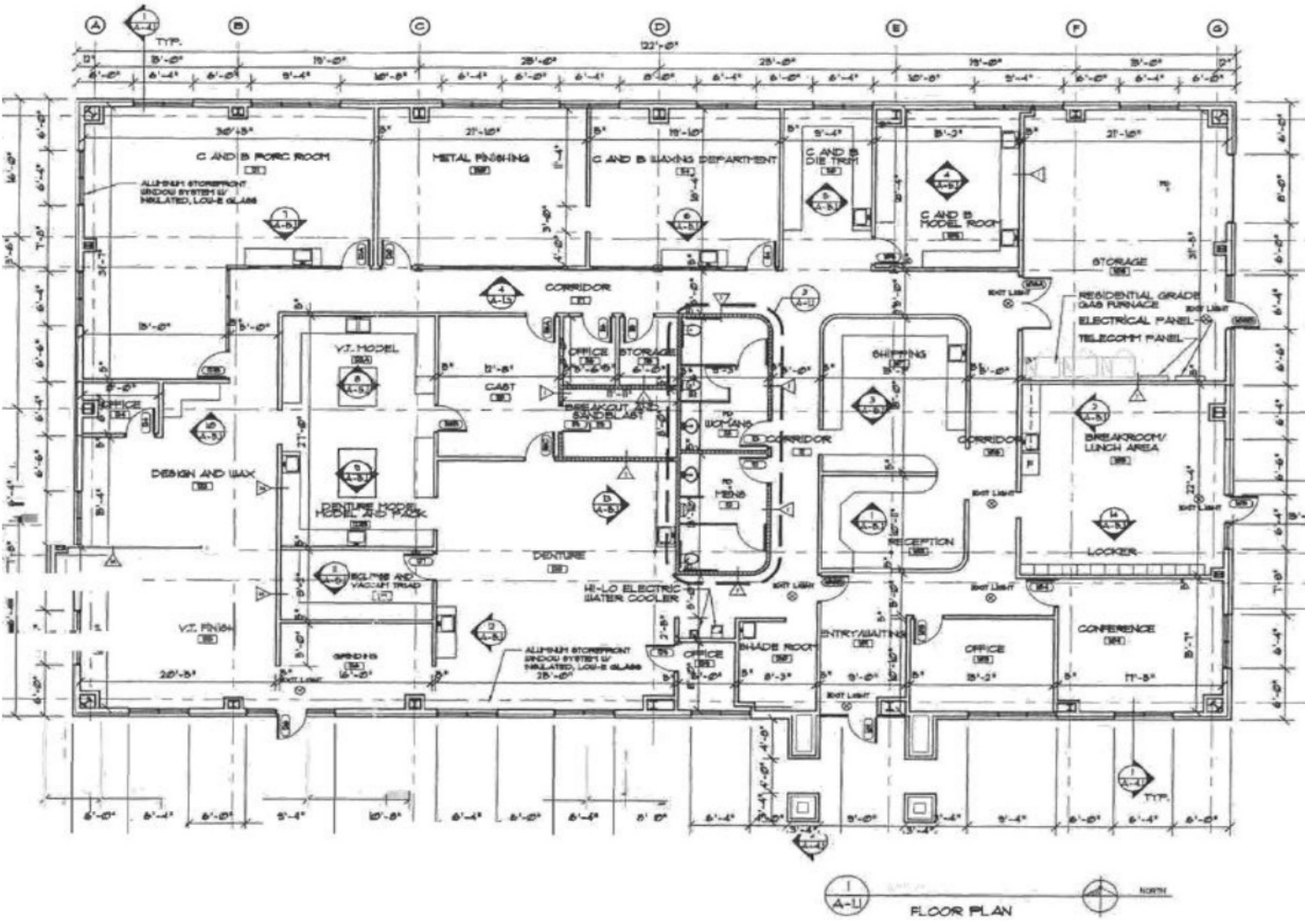

For Lease | Lab Building | 5001 World Dairy Drive, Madison, WI 53718

Lab Photos

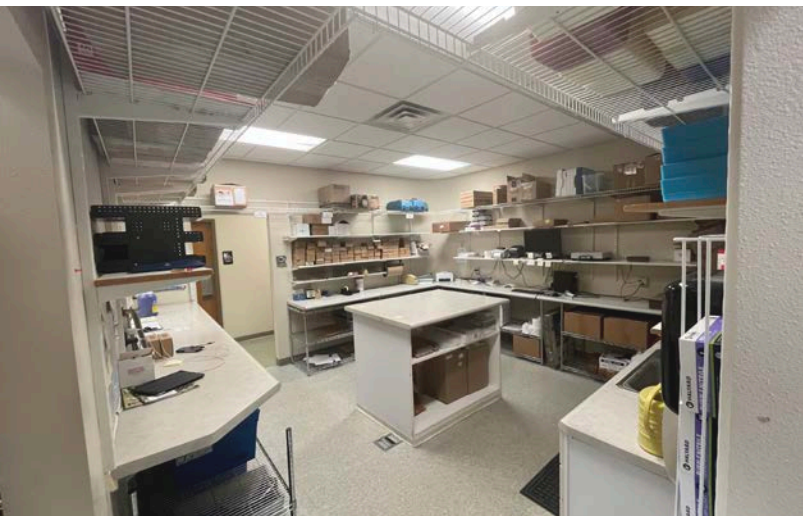

For Lease | Lab Building | 5001 World Dairy Drive, Madison, WI 53718

Additional Photos



For Lease | 5001 World Dairy Dr

Contact Us:

Chris Richards

Partner

+1 608 628 5895

chris.richards@colliers.com

Colin McLandsborough

Real Estate Advisor

+1 262 309 5597

colin.mclandsborough@colliers.com

Dustin Pate

Senior Real Estate Advisor

+1 608 867 7471

dustin.pate@colliers.com

Colliers | Wisconsin

316 W Washington Ave, suite 925

Madison, WI 53703

P: +1 608 826 9500

colliers.com

