

OFFICE FOR LEASE (1,573 - 6,000 RSF)

MIDVALE PROFESSIONAL BUILDING - HILLDALE

310 N. MIDVALE BLVD, MADISON, WI 53705



FOR LEASE - NEGOTIABLE LEASE RATE

OAKBROOK CORPORATION
2 Science Court, Suite 200
Madison, WI 53711



PRESENTED BY:

BRYANT MEYER, CCIM
Broker, Associate
office: (608) 443-1004
cell: (608) 633-2242
bmeyer@oakbrookcorp.com

TONY KEUNTJES
CRE Associate
office: (608) 443-1039
cell: (715) 451-3252
akeuntjes@oakbrookcorp.com

The calculations and data presented are deemed to be accurate, but not guaranteed. They are intended for the purpose of illustrative projections and analysis. The information provided is not intended to replace or serve as substitute for any legal, accounting, investment, real estate, tax or other professional advice, consultation or service. The user of this software should consult with a professional in the respective legal, accounting, tax or other professional area before making any decisions.

PROPERTY SUMMARY

310 NORTH MIDVALE BOULEVARD



Property Summary

Lease Rate:	Negotiable
Available SF:	1,573 - 6,000 RSF
Suite 201	2,079 RSF
Suite 202	1,573 RSF
Suite 205	3,111 RSF
Suite 304	(subdividable) 6,000 RSF
Elevators:	Yes
Floors:	2nd & 3rd Floor Space
Parking:	Exterior Surface & Covered
Signage:	Monument & Directory
Additional Amenities:	Storage & Break Room
Tenant Improvement:	Yes

Property Overview

Three-story office building adjacent to Hilldale Shopping Center with elevator, exterior covered/non-covered parking, common restrooms, and a common breakroom with vending and storage.

This is a full service gross lease offering with all utilities and janitorial included. Tenant is separately responsible for phone/data services. Occupancy available now.

Building Exterior Signage available for Suite 304 tenant.

Landlord willing to provide turn-key tenant improvements.

Location Overview

Located on Madison's near west side adjacent to the desirable Hilldale Shopping Center, a laidback strollable setting with numerous upscale shopping, restaurant venues and community events.

OAKBROOK CORPORATION
2 Science Court, Suite 200
Madison, WI 53711



BRYANT MEYER, CCIM
Broker, Associate
O: (608) 443-1004
C: (608) 633-2242
bmeyer@oakbrookcorp.com

TONY KEUNTJES
CRE Associate
O: (608) 443-1039
C: (715) 451-3252
akeuntjes@oakbrookcorp.com

PROPERTY PHOTOS

310 NORTH MIDVALE BOULEVARD



OAKBROOK CORPORATION
2 Science Court, Suite 200
Madison, WI 53711



BRYANT MEYER, CCIM
Broker, Associate
O: (608) 443-1004
C: (608) 633-2242
bmeyer@oakbrookcorp.com

TONY KEUNTJES
CRE Associate
O: (608) 443-1039
C: (715) 451-3252
akeuntjes@oakbrookcorp.com

PROPERTY PHOTOS

310 NORTH MIDVALE BOULEVARD



OAKBROOK CORPORATION
2 Science Court, Suite 200
Madison, WI 53711



BRYANT MEYER, CCIM
Broker, Associate
O: (608) 443-1004
C: (608) 633-2242
bmeyer@oakbrookcorp.com

TONY KEUNTJES
CRE Associate
O: (608) 443-1039
C: (715) 451-3252
akeuntjes@oakbrookcorp.com

BUILDING EXTERIOR SIGNAGE AVAILABLE

310 NORTH MIDVALE BOULEVARD



OAKBROOK CORPORATION
2 Science Court, Suite 200
Madison, WI 53711



BRYANT MEYER, CCIM
Broker, Associate
O: (608) 443-1004
C: (608) 633-2242
bmeyer@oakbrookcorp.com

TONY KEUNTJES
CRE Associate
O: (608) 443-1039
C: (715) 451-3252
tkeuntjes@oakbrookcorp.com

SUITE 304: (SUBDIVIDABLE)

310 NORTH MIDVALE BOULEVARD

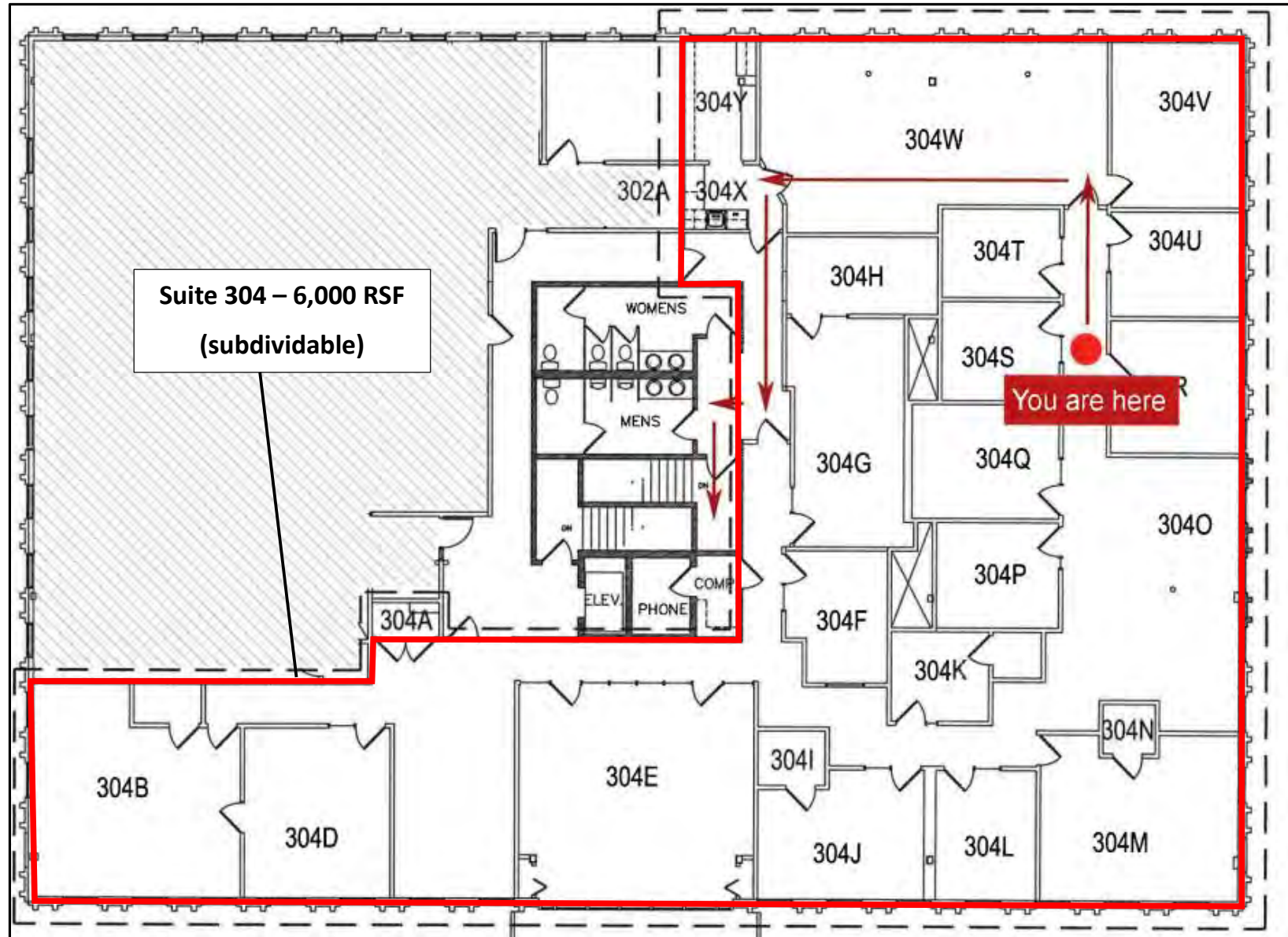

OAKBROOK CORPORATION
2 Science Court, Suite 200
Madison, WI 53711

BRYANT MEYER, CCIM
Broker, Associate
O: (608) 443-1004
C: (608) 633-2242
bmeyer@oakbrookcorp.com

TONY KEUNTJES
CRE Associate
O: (608) 443-1039
C: (715) 451-3252
akeuntjes@oakbrookcorp.com

SUITE 201: 2,079 RSF

310 NORTH MIDVALE BOULEVARD

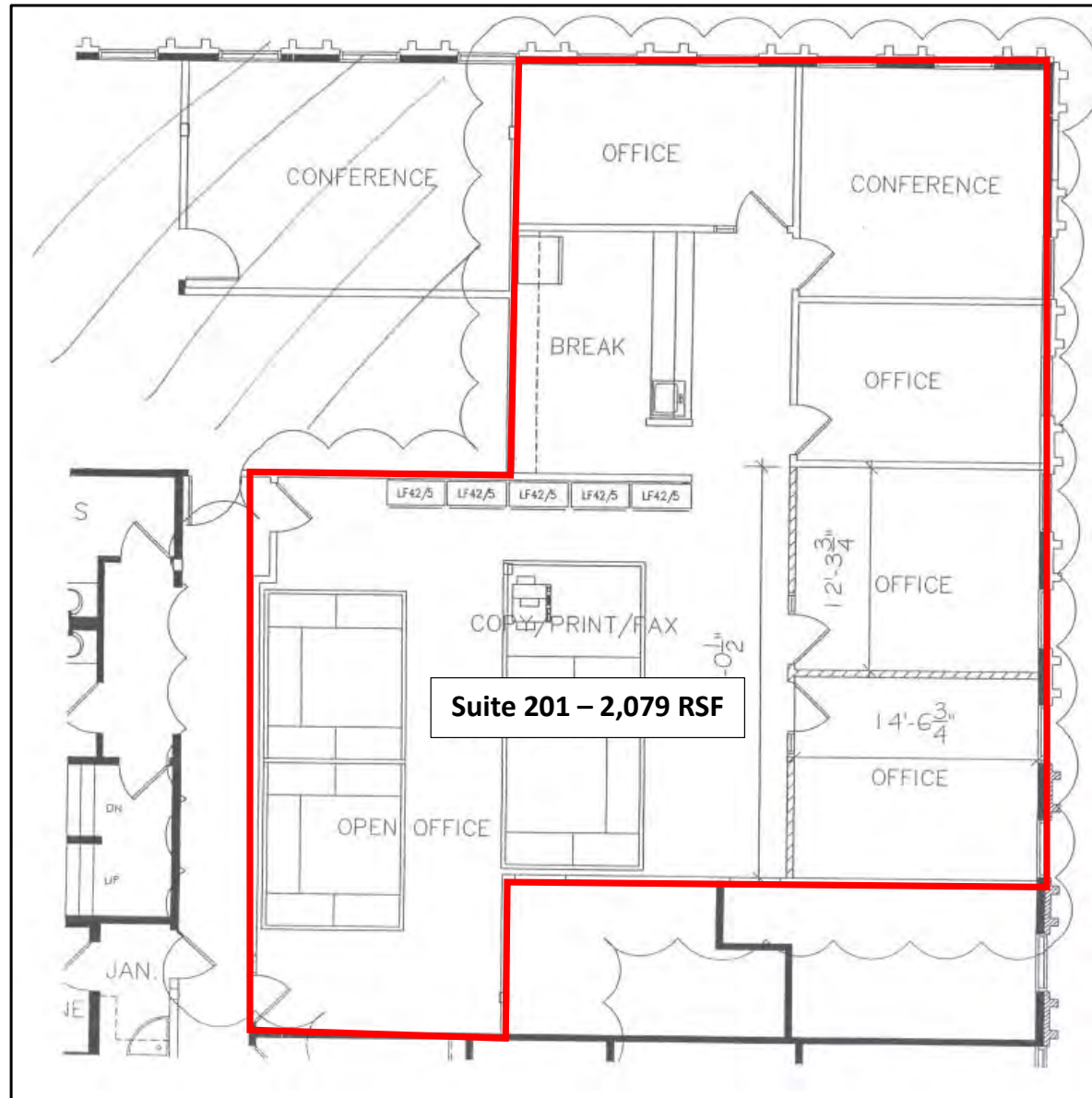

Suite 201 – 2,079 RSF

OAKBROOK CORPORATION
2 Science Court, Suite 200
Madison, WI 53711



BRYANT MEYER, CCIM
Broker, Associate
O: (608) 443-1004
C: (608) 633-2242
bmeyer@oakbrookcorp.com

TONY KEUNTJES
CRE Associate
O: (608) 443-1039
C: (715) 451-3252
akeuntjes@oakbrookcorp.com

SUITE 202: 1,573 RSF
310 NORTH MIDVALE BOULEVARD

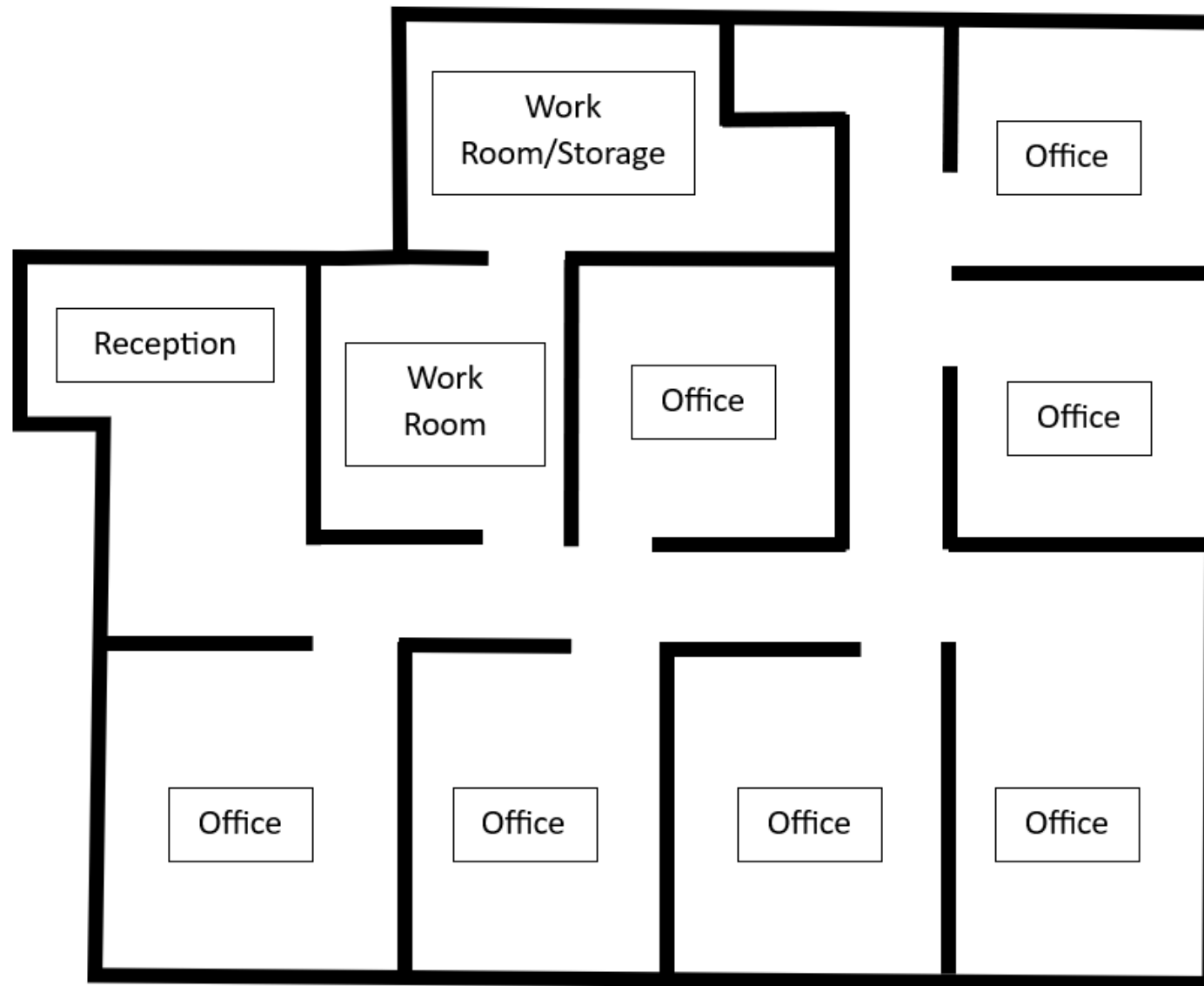

SUITE 205: 3,111 RSF

310 NORTH MIDVALE BOULEVARD



LOCATION MAPS

310 NORTH MIDVALE BOULEVARD



OAKBROOK CORPORATION
2 Science Court, Suite 200
Madison, WI 53711



BRYANT MEYER, CCIM
Broker, Associate
O: (608) 443-1004
C: (608) 633-2242
bmeyer@oakbrookcorp.com

TONY KEUNTJES
CRE Associate
O: (608) 443-1039
C: (715) 451-3252
akeuntjes@oakbrookcorp.com

BUSINESS MAP

310 NORTH MIDVALE BOULEVARD





 Crumbl Cookies - Madison

 UW Credit Union

 Park Bank

 Bucciferro Family McDonald's

 Walgreens Pharmacy

 Panera Bread

 Target

 U.S. Bank Branch

 Starbucks

 Chase Bank

 SpringHill Suites by Marriott Madison

 Princeton Club Xpress Madison-Hilldale

 Café Hollander Hilldale

 Hilldale Shopping Center

 bartaco

 CRESCENDO Crescendo Espresso Bar

 United States Postal Service

 Levi's Store

 University Book Store: Hilldale

 TWIGS Twigs

 L.L.Bean

 Gigi's Cupcakes

 CYCLEBAR

 Niemann Ace Hardware

 Old National Bank

 Bambu

DISCLAIMER

310 NORTH MIDVALE BOULEVARD



All materials and information received or derived from Oakbrook Corporation its directors, officers, agents, advisors, affiliates and/or any third party sources are provided without representation or warranty as to completeness, veracity, or accuracy, condition of the property, compliance or lack of compliance with applicable governmental requirements, developability or suitability, financial performance of the property, projected financial performance of the property for any party's intended use or any and all other matters.

Neither Oakbrook Corporation its directors, officers, agents, advisors, or affiliates makes any representation or warranty, express or implied, as to accuracy or completeness of the any materials or information provided, derived, or received. Materials and information from any source, whether written or verbal, that may be furnished for review are not a substitute for a party's active conduct of its own due diligence to determine these and other matters of significance to such party. Oakbrook Corporation will not investigate or verify any such matters or conduct due diligence for a party unless otherwise agreed in writing.

EACH PARTY SHALL CONDUCT ITS OWN INDEPENDENT INVESTIGATION AND DUE DILIGENCE.

Any party contemplating or under contract or in escrow for a transaction is urged to verify all information and to conduct their own inspections and investigations including through appropriate third-party independent professionals selected by such party. All financial data should be verified by the party including by obtaining and reading applicable documents and reports and consulting appropriate independent professionals. Oakbrook Corporation makes no warranties and/or representations regarding the veracity, completeness, or relevance of any financial data or assumptions. Oakbrook Corporation does not serve as a financial advisor to any party regarding any proposed transaction.

All data and assumptions regarding financial performance, including that used for financial modeling purposes, may differ from actual data or performance. Any estimates of market rents and/or projected rents that may be provided to a party do not necessarily mean that rents can be established at or increased to that level. Parties must evaluate any applicable contractual and governmental limitations as well as market conditions, vacancy factors and other issues in order to determine rents from or for the property. Legal questions should be discussed by the party with an attorney. Tax questions should be discussed by the party with a certified public accountant or tax attorney. Title questions should be discussed by the party with a title officer or attorney. Questions regarding the condition of the property and whether the property complies with applicable governmental requirements should be discussed by the party with appropriate engineers, architects, contractors, other consultants, and governmental agencies. All properties and services are marketed by Oakbrook Corporation in compliance with all applicable fair housing and equal opportunity laws.

OAKBROOK CORPORATION
2 Science Court, Suite 200
Madison, WI 53711



PRESENTED BY:

BRYANT MEYER, CCIM
Broker, Associate
O: (608) 443-1004
C: (608) 633-2242
bmeyer@oakbrookcorp.com

TONY KEUNTJES
CRE Associate
O: (608) 443-1039
C: (715) 451-3252
akeuntjes@oakbrookcorp.com

The calculations and data presented are deemed to be accurate, but not guaranteed. They are intended for the purpose of illustrative projections and analysis. The information provided is not intended to replace or serve as substitute for any legal, accounting, investment, real estate, tax or other professional advice, consultation or service. The user of this software should consult with a professional in the respective legal, accounting, tax or other professional area before making any decisions.