

All plantings shown are existing  
Landscaping Plan provided by: Edward Solner, architect  
Date of Plan: July 1981

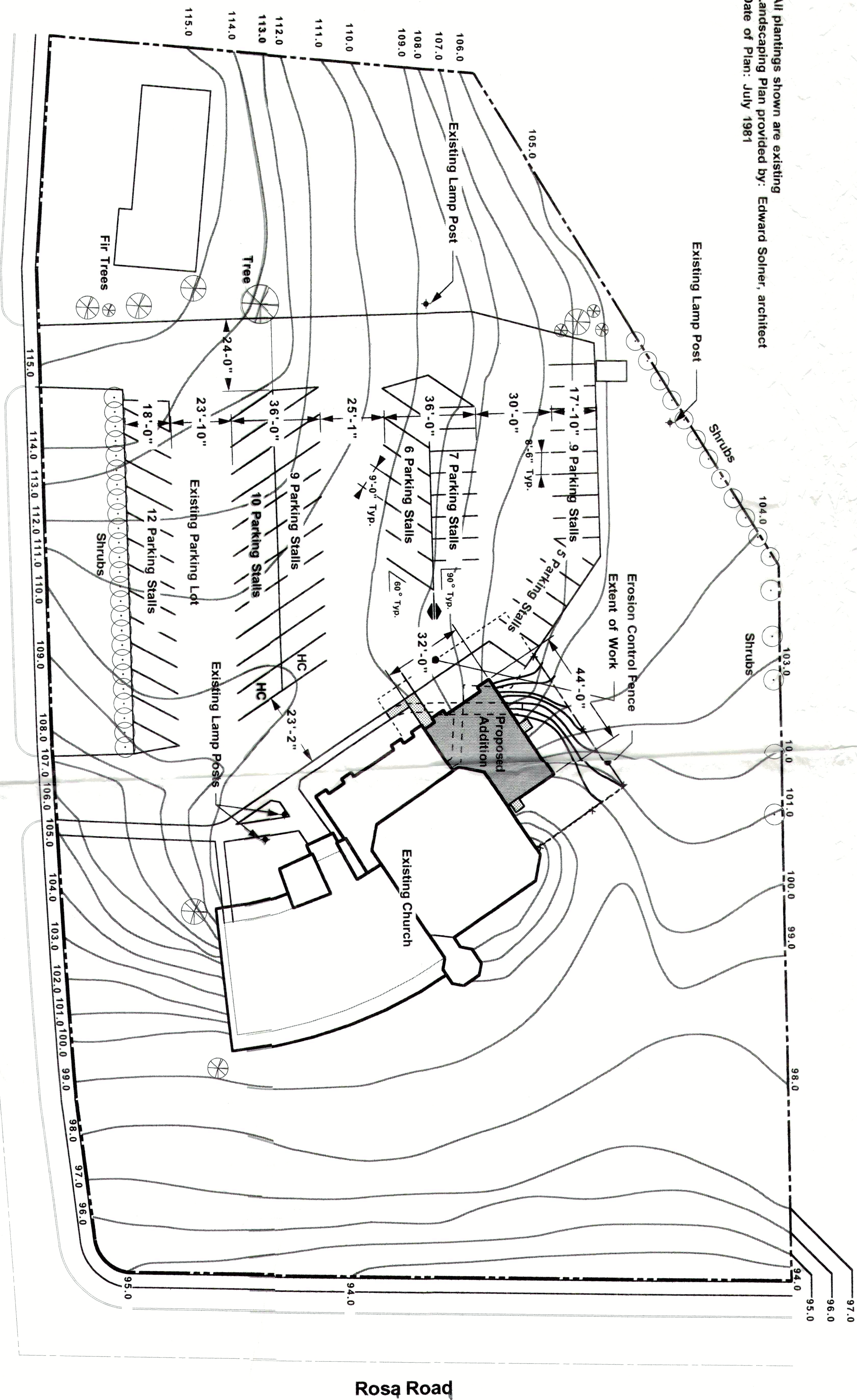

**Site Information:**

Parking Provided: 60 Spaces

Handicapped Parking Provided: 2 Spaces

Required Parking:

$\left[ \frac{\text{Area of Nave} = 2685 \text{ SF}}{7 \text{ square feet/person}} \right]$

= 39 Spaces Required

10 People/Staff

Use of Property: Church  
Total Square Footage of Addition: 2430

South Hill Drive



Plan North



True North

**Site Plan**

Scale: 1" = 20'-0"

Revision

**Divine Savior  
United Methodist Church**  
5702 South Hill Drive  
Madison, Wisconsin

**ani**  
ARCHITECTURE  
NETWORK, INC

**arlan kay & associates**  
Architecture, Planning, Building Recycling  
110 King Street, Madison, WI 53703  
Telephone 608-251-7515 FAX: 608-255-1764

Drawn by

Date  
11 Mar 94

Project no.  
K93337

Sheet no.

1.2