

2023 Property Records for City of Fitchburg, Dane County

July 12, 2023

Tax key number: 0609-013-8050-9

Property address: 4917 E Clayton Rd

Traffic / water / sanitary: Heavy / Shared well / Sewer

Summary of Assessment	
Land	\$518,300
Improvements	\$6,200
Total value	\$524,500

Land									
Qty	Land Use	Width	Depth	Square Feet	Acres	Water Frontage	Tax Class	Special Tax Program	Assess Value
8	Commercial			236,269	5.424	None	Commercial		\$488,200
1	Primary forest			139,392	3.200	None	Forest		\$30,100

Residential Building									
Year built:	1925	Full basement:	960 SF						
Year remodeled:		Crawl space:							
Stories:	2 story	Rec room (rating):							
Style:	Old style	Fin bsmt living area:							
Use:	Commercial	First floor:	1,356 SF						
Exterior wall:	Wood	Second floor:	768 SF						
Masonry adjust:		Third floor:							
Roof type:	Asphalt shingles	Half story:	0 SF						
Heating:	Gas, hot water	Finished attic:							
Cooling:	No A/C	Unfinished attic:							
Bedrooms:	4	Unfinished area:							
Family rooms:	1	Screen porch	320 SF						
Baths:	2 full, 1 half								
Other rooms:	3								
Whirl / hot tubs:									
Add'l plumb fixt:	2								
Masonry FPs:	1 stacks, 1 openings								
Metal FPs:									
Gas only FPs:									
Bsmt garage:		Grade:	D+						
Shed dormers:		Condition:	Fair						
Gable/hip dorm:		Percent complete:	100%						

Total living area is 2,124 SF; building assessed value is n/a

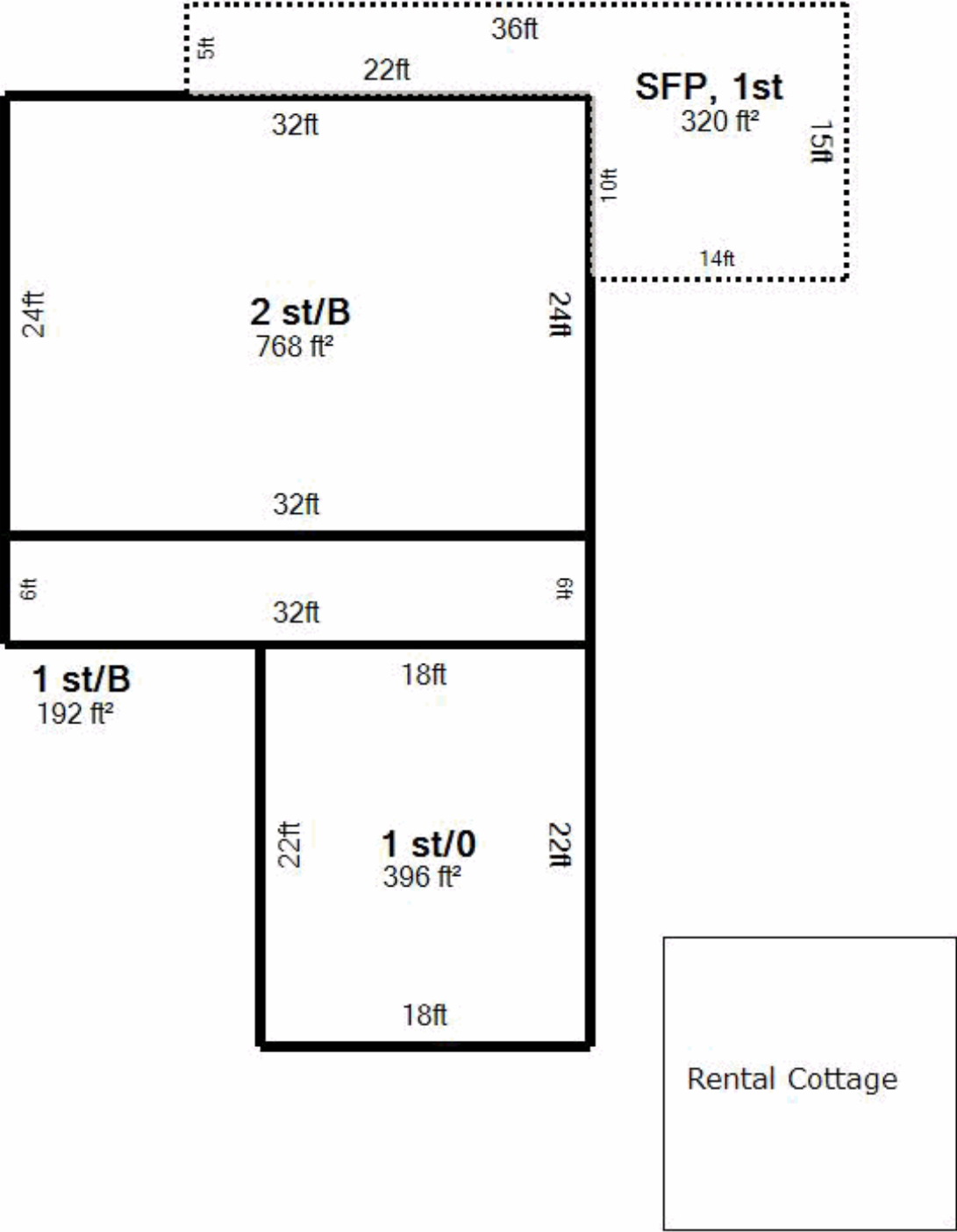

Commercial Building (Springwood Motel 6 Unit)

Section name: Section 1
 Year built: 1950
 % complete: 100%
 Stories: 1.00
 Perimeter: 256 LF
 Total area: 2,018 SF (all stories)



Occupancies	Designed Use		Actual Use		Units	Area per Unit	Construction Class		Avg Ht	Quality	CDU	
	Motel Room, 1 sty, sgl row		Apartment, efficiency		6	325	Wood or steel framed exterior w		8.00	D (FR)	Fair	
	Motel Room, 1 sty, sgl row		Support area		1	68	Wood or steel framed exterior w		8.00	D (FR)	Fair	
Exterior walls HVAC	Component Description				Count	Stops	Area (sf)	Area (%)	Quality			
	Stud-Walls-Wood Siding						2,018	100.0%	C (AV)			
	Electric						2,018	100.0%	C (AV)			
Attachments	Qty	Attachment Type	Construction Type		Area	Modifications (Type, Size)			Grade	% Comp	Yr Blt	Condition
	1	Garage	Frame or cb		660				D	100%	1950	FR

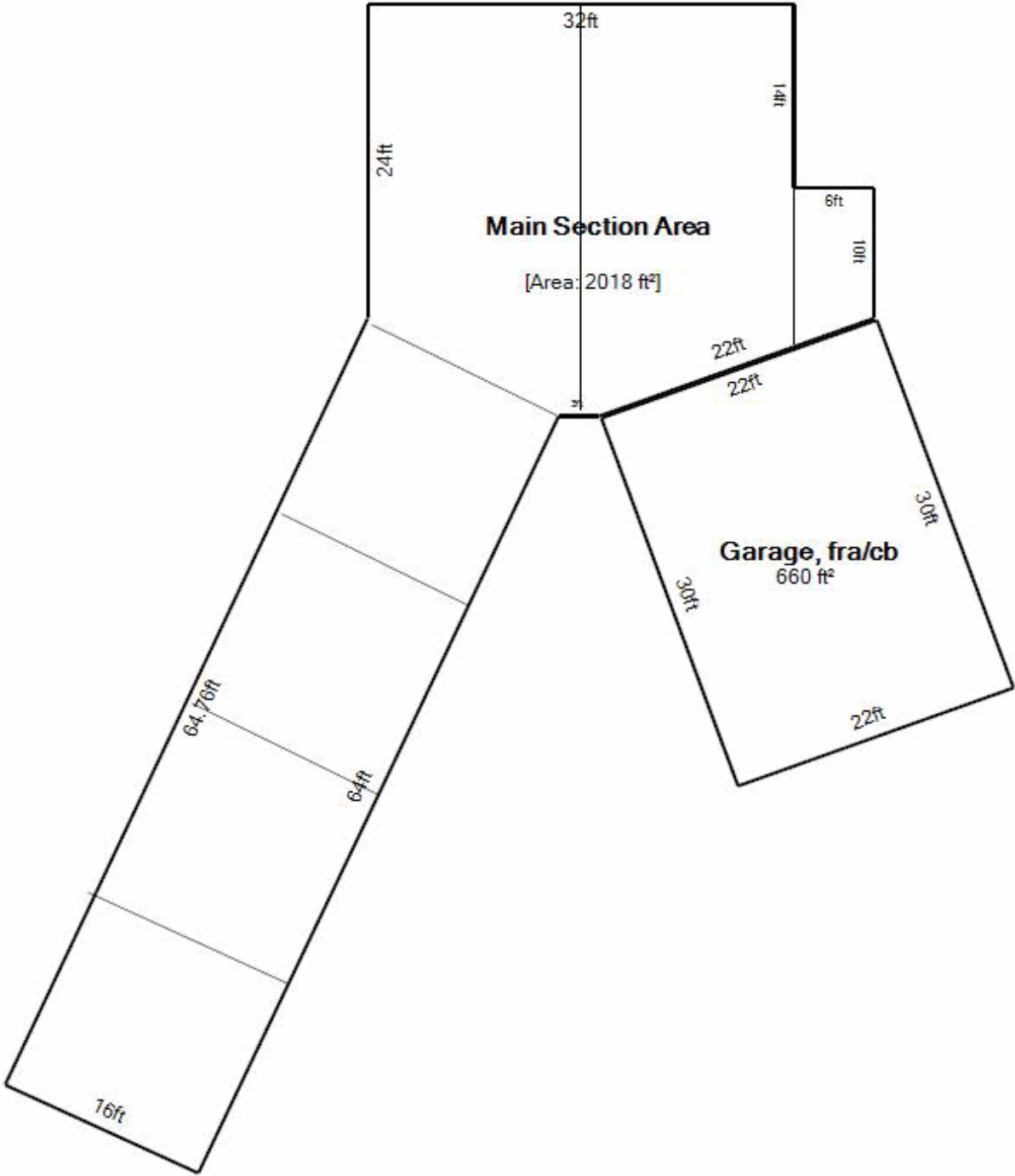

Commercial Building (Rental)

Section name: Section 1
 Year built: 1950
 % complete: 100%
 Stories: 1.00
 Perimeter: 64 LF
 Total area: 256 SF (all stories)



Occupancies	Designed Use	Actual Use		Units	Area per Unit	Construction Class	Avg Ht	Quality	CDU
	Motel	Room (boarding house)		1	256	Wood or steel framed exterior w	8.00	D (FR)	Fair
Exterior walls	Component Description		Count	Stops	Area (sf)	Area (%)	Quality		
	Stud-Walls-Wood Siding				256	100.0%	C (AV)		
HVAC	Space heater				256	100.0%	C (AV)		

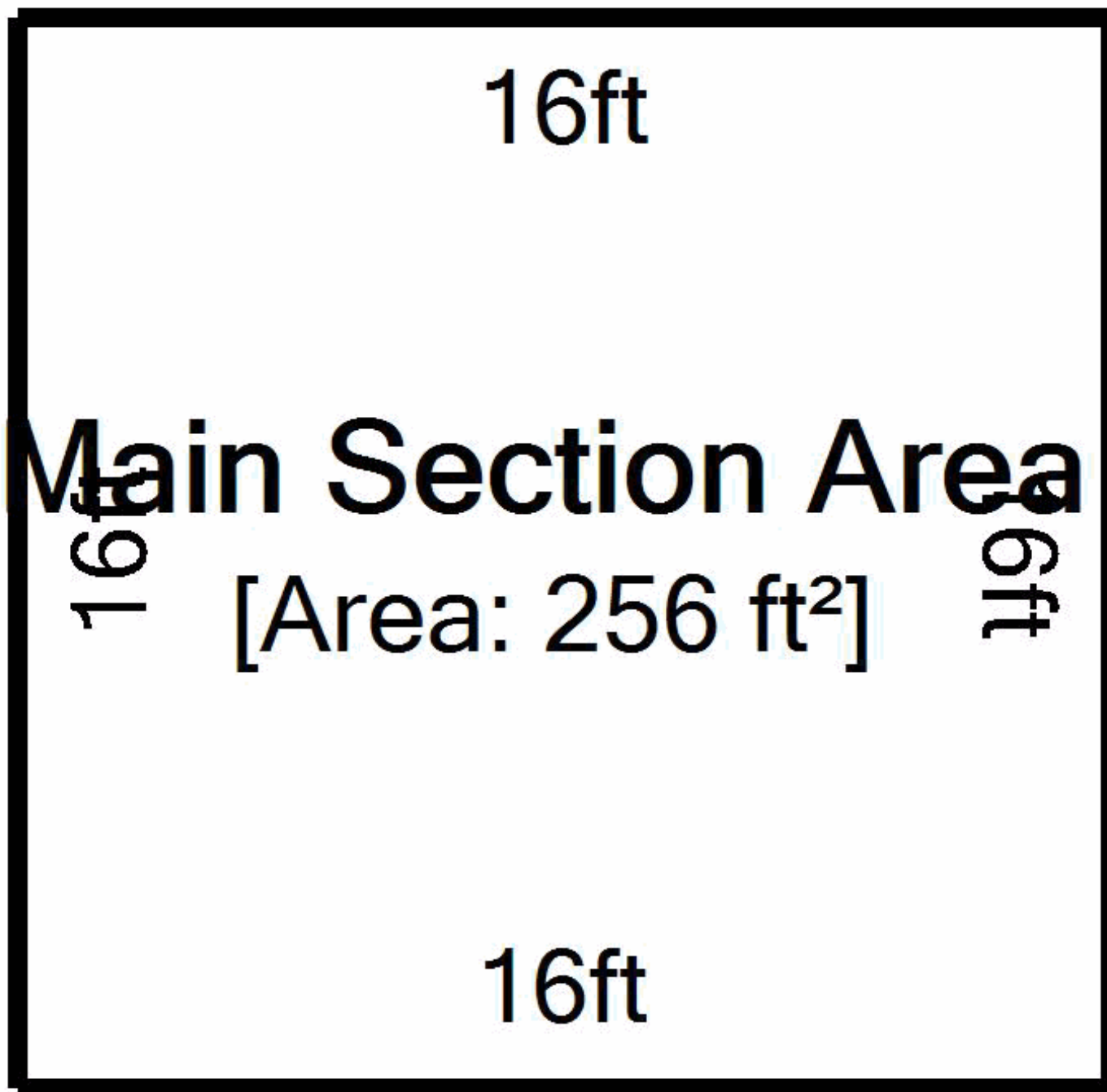

2023 Property Records for City of Fitchburg, Dane County

July 12, 2023

# of identical OBIs: 1		Other Building Improvement (OBI)		
Main Structure		Modifications (Type, Size)		Photograph
OBI type: Asphalt parking	Width: 80 LF	Grade: C		not available
Const type: Std construction	Depth: 125 LF	Condition: Fair		
Year built: 1990	Floor area: 10,000 SF	% complete: 100%		
		Assessed \$: n/a		

Other Improvements		
Tax Class	Description	Assess Value
Commercial	Apartment Income	\$6,200

Building Permits				
Issued	Permit #	Purpose	\$ Amount	Completed
10/26/2017	836-17	Elec service upgrade	\$4,000	12/21/2017

Sales History		
Date	Price	Type