

Office Space in
Premier Location on
Capitol Square



Available for **SUBLEASE**

- Outstanding Capitol & lake views
- Convenient visitor parking
- On-site bank and coffee shop
- Locker Room with showers
- High End, Class A finishes & furniture throughout



Michael Streit,
Executive Vice President
direct + 1 414 944 2104
michael.streit@am.jll.com

Jones Lang LaSalle Brokerage, Inc. a licensed real estate broker.

25 West Main

25 W. Main Street, Madison, WI 53703

Lease Terms

Total Available:	57,479 RSF
6th Floor:	20,219 RSF
8th Floor:	20,515 RSF
9th Floor:	16,745 RSF
Expiration:	May 31, 2030

Building Details

Building Size:	198,000 SF
Floors:	8
Class:	A
Built / Renovated:	1963 / 2017
Parking:	Ample

6TH FLOOR 20,219 RSF

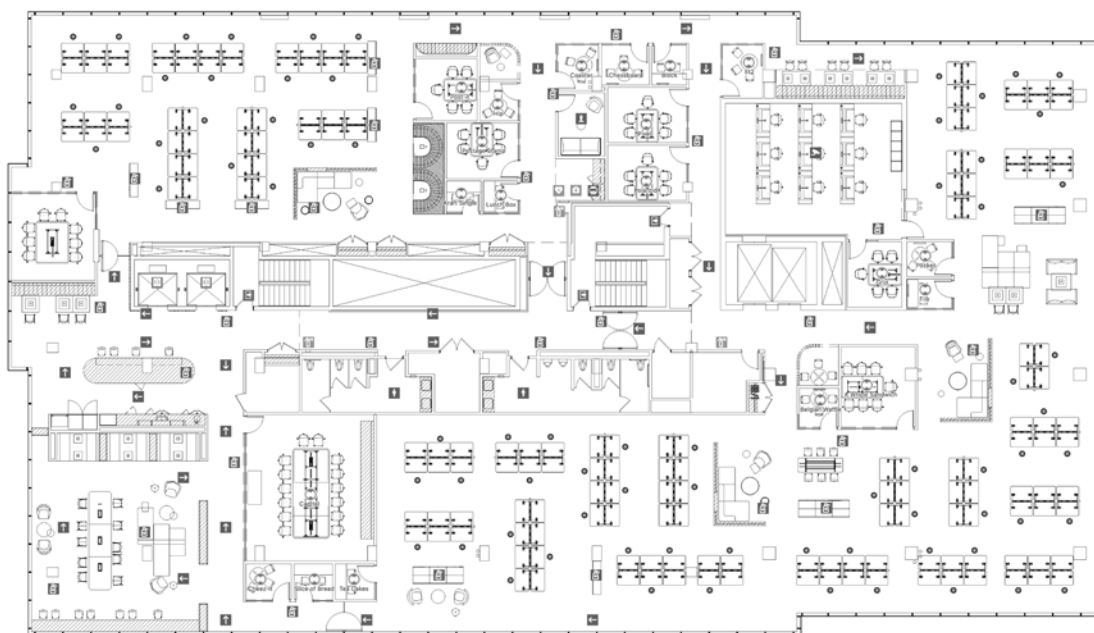

8TH FLOOR 20,515 RSF

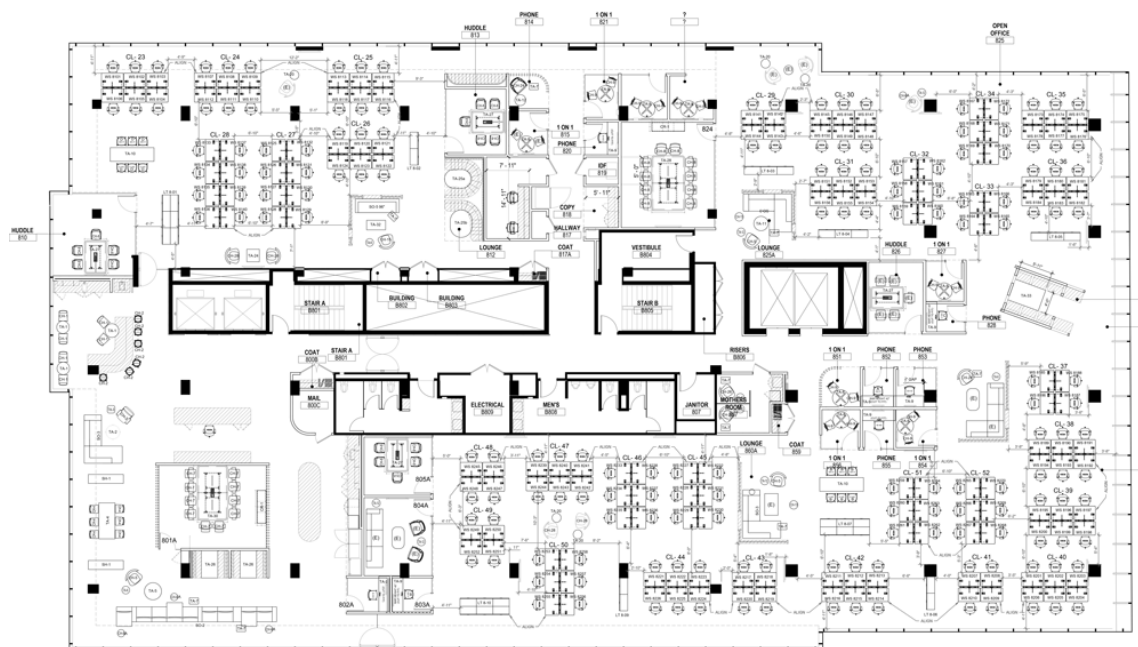

9TH FLOOR 16,745 RSF

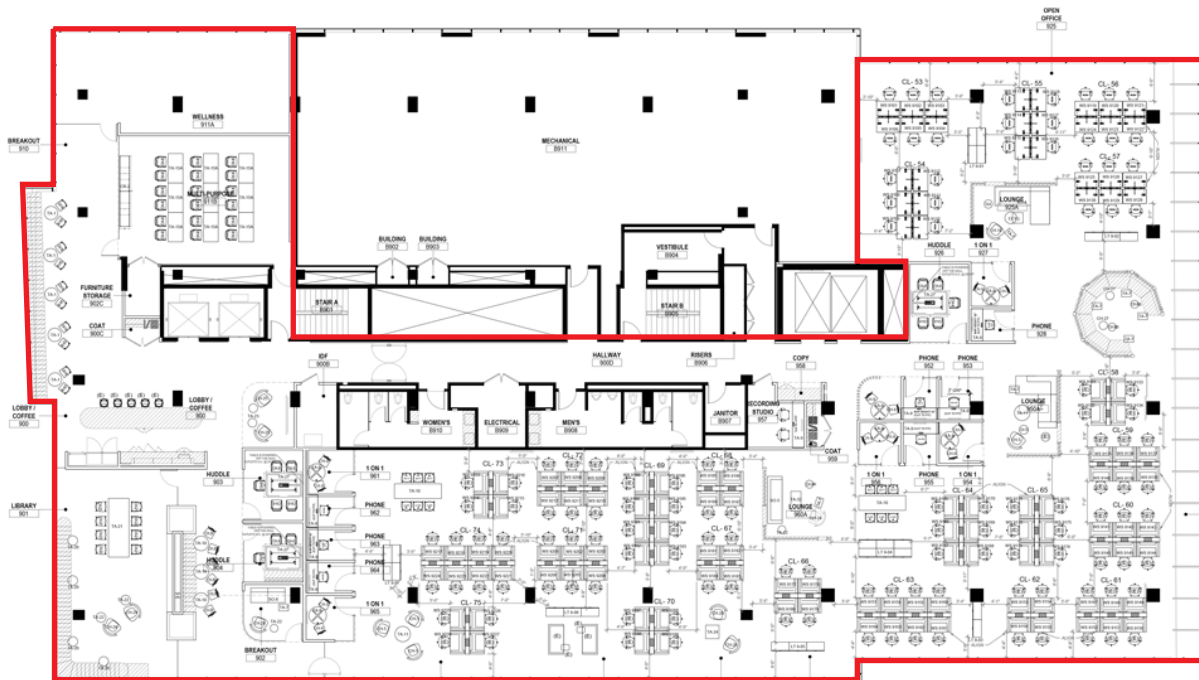

Interior Photos

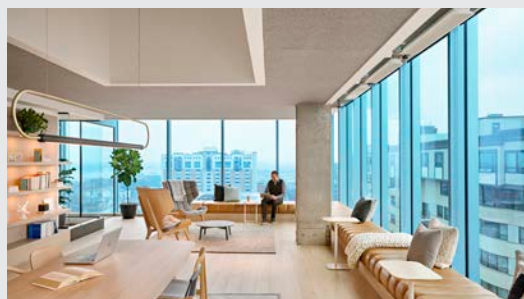



sublease

25 West Main

25 W. Main Street, Madison, WI 53703



Michael Streit,
Executive Vice President
direct + 1 414 944 2104
michael.streit@am.jll.com

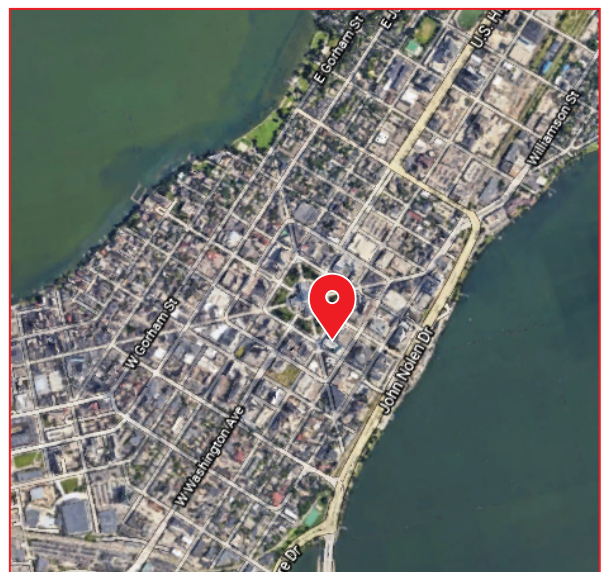

DISCLAIMER

disclaimer: Although information has been obtained from sources deemed reliable, Owner, Jones Lang LaSalle, and/or their representatives, brokers or agents make no guarantees as to the accuracy of the information contained herein, and offer the Property without express or implied warranties of any kind. The Property may be withdrawn without notice. If the recipient of this information has signed a confidentiality agreement regarding this matter, this information is subject to the terms of that agreement. ©2021. Jones Lang LaSalle. All rights reserved.