

# Pre-Leasing Commercial Space

## The Edge at Conservancy

4898 Innovation Dr, DeForest WI 53532



Now preleasing The Edge at Conservancy! This mixed-use community offers a live, work, play experience that will be available Summer of 2022. The commercial retail/office space sets itself apart offering the most convenient retail opportunity available to the thousands of neighbors within the Conservancy Place development. It is conveniently located near ABS Global Headquarters and across the street from DeForest Athletic Complex which is the host to hundreds of events annually. The Edge at Conservancy offers 1,000-8,000 SF of Class A Retail/Office. This property is great for a coffeehouse, small fitness user, and service businesses such as insurance agents or financial advisors.

BEN FILKOUSKI

608.709.5555 X4 608.333.7734

[Ben.filkouski@madisoncommercialre.com](mailto:Ben.filkouski@madisoncommercialre.com)

MIKE OSBORNE, CCIM

608.709.5555 x3 608.575.1777

[Mike.osborne@madisoncommercialre.com](mailto:Mike.osborne@madisoncommercialre.com)

Madison Commercial Real Estate LLC, 5609 Medical Cr, Suite 202, Madison WI 53719



# Pre-Leasing Commercial Space

## The Edge at Conservancy

4898 Innovation Dr, DeForest WI 53532

**M**<sup>MADISON</sup>  
**C**<sup>COMMERCIAL</sup>  
REAL ESTATE LLC



### Building Details

- > Available Space: 1,000 - 8,000 sqft
- > Parking: Surface/Heated Garage
- > Availability: Summer 2022
- > Term: 5 years
- > TI Allowance: Negotiable
- > Utilities: Tenant Responsible
- > Asking Price: \$19.00 - \$22.00/sqft MG

### Property Highlights

- > New development with first generation Class A retail/office space available.
- > Excellent visibility from Interstate 90-94
- > Across the street from the new DeForest Athletic Complex
- > Shared rooftop garden & conference rooms
- > Onsite underground & surface parking

BEN FILKOUSKI

608.709.5555 X4 608.333.7734

Ben.filkouski@madisoncommercialre.com

MIKE OSBORNE, CCIM

608.709.5555 x3 608.575.1777

Mike.osborne@madisoncommercialre.com

Madison Commercial Real Estate LLC, 5609 Medical Cr, Suite 202, Madison WI 53719



# Pre-Leasing Commercial Space

## The Edge at Conservancy

4898 Innovation Dr, DeForest WI 53532

**M**<sup>ADISON</sup>  
**C**<sup>OMMERCIAL</sup>  
REAL ESTATE LLC



### 2021 Demographics

	<u>1 Mile</u>	<u>3 Mile</u>	<u>5 Mile</u>
Population	2,280	17,419	28,835
# Households	848	6,771	10,783
Avg HH Income	\$115,154	\$107,937	\$116,031
# Businesses	27	425	857
# Employees	570	7,363	14,518

BEN FILKOUSKI

608.709.5555 X4 608.333.7734

Ben.filkouski@madisoncommercialre.com

MIKE OSBORNE, CCIM

608.709.5555 x3 608.575.1777

Mike.osborne@madisoncommercialre.com

Madison Commercial Real Estate LLC, 5609 Medical Cr, Suite 202, Madison WI 53719

# Pre-Leasing Commercial Space

## The Edge at Conservancy

4898 Innovation Dr, DeForest WI 53532

**MADISON**  
**COMMERCIAL**  
REAL ESTATE LLC



## Proposed Floor Plan

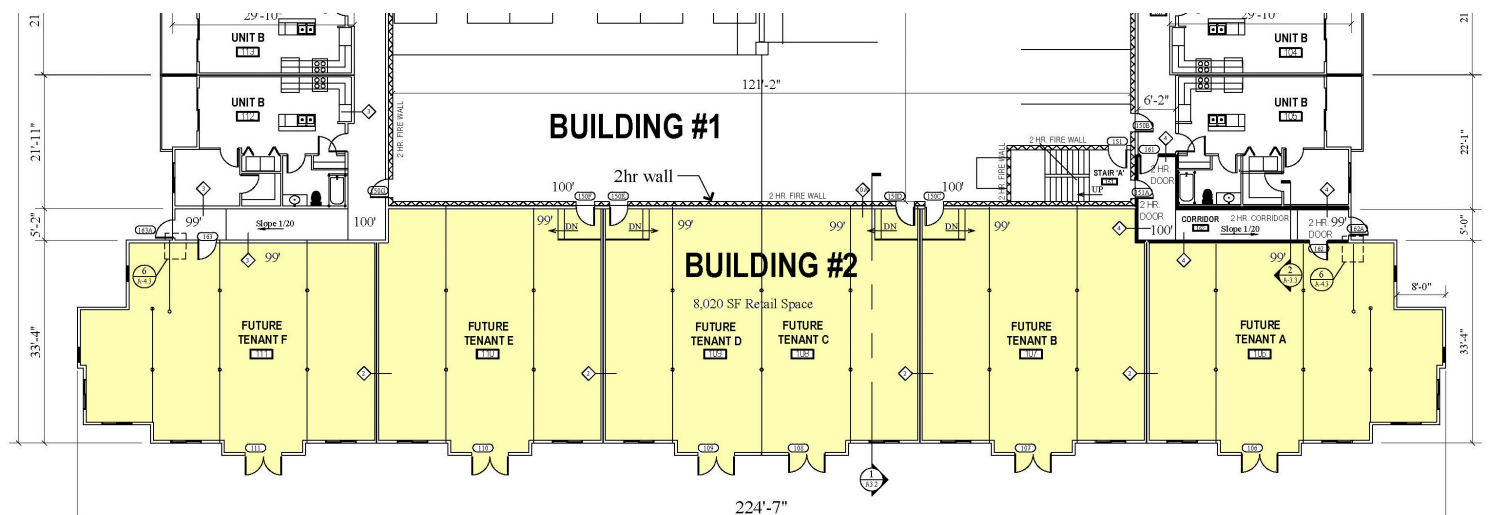

First Floor Plan

Scale = 1/8"=1'-0"

BEN FILKOUSKI

608.709.5555 X4 608.333.7734

Ben.filkouski@madisoncommercialre.com

MIKE OSBORNE, CCIM

608.709.5555 x3 608.575.1777

Mike.osborne@madisoncommercialre.com

Madison Commercial Real Estate LLC, 5609 Medical Cr, Suite 202, Madison WI 53719



## BROKER DISCLOSURE TO NON-RESIDENTIAL CUSTOMERS

1 Prior to negotiating on your behalf the Broker must provide you the following disclosure statement:

### BROKER DISCLOSURE TO CUSTOMERS

3 You are a customer of the broker. The broker is either an agent of another party in the transaction or a subagent of another broker who is the agent of another party in the transaction. The broker, or a salesperson acting on behalf of the broker, may provide brokerage services to you. Whenever the broker is providing brokerage services to you, the broker owes you, the customer, the following duties:

- 7 ■ The duty to provide brokerage services to you fairly and honestly.
- 8 ■ The duty to exercise reasonable skill and care in providing brokerage services to you.
- 9 ■ The duty to provide you with accurate information about market conditions with a reasonable time if you request it, unless disclosure of the information is prohibited by law.
- 11 ■ The duty to disclose to you in writing certain material adverse facts about a property, unless disclosure of the information is prohibited by law (See Lines 47-55).
- 13 ■ The duty to protect your confidentiality. Unless the law requires it, the broker will not disclose your confidential information or the confidential information of other parties (See Lines 22-39).
- 15 ■ The duty to safeguard trust funds and other property the broker holds.
- 16 ■ The duty, when negotiating, to present contract proposals in an objective and unbiased manner and disclose the advantages and disadvantages of the proposals.

18 Please review this information carefully. A broker or salesperson can answer your questions about brokerage services, but if you need legal advice, tax advice, or a professional home inspection, contact an attorney, tax advisor, or home inspector. This disclosure is required by section 452.135 of the Wisconsin statutes and is for information only. It is a plain-language summary of A broker's duties to a customer under section 452.133 (1) of the Wisconsin statutes.

### CONFIDENTIALITY NOTICE TO CUSTOMERS

23 BROKER WILL KEEP CONFIDENTIAL ANY INFORMATION GIVEN TO BROKER IN CONFIDENCE, OR ANY INFORMATION OBTAINED BY BROKER THAT HE OR SHE KNOWS A REASONABLE PERSON WOULD WANT TO BE KEPT CONFIDENTIAL, UNLESS THE INFORMATION MUST BE DISCLOSED BY LAW OR YOU AUTHORIZE THE BROKER TO DISCLOSE PARTICULAR INFORMATION. A BROKER SHALL CONTINUE TO KEEP THE INFORMATION CONFIDENTIAL AFTER BROKER IS NO LONGER PROVIDING BROKERAGE SERVICES TO YOU.

28 THE FOLLOWING INFORMATION IS REQUIRED TO BE DISCLOSED BY LAW:

- 29 1. MATERIAL ADVERSE FACTS, AS DEFINED IN SECTION 452.01 (5g) OF THE WISCONSIN STATUTES (SEE LINES 47-55).
- 30 2. ANY FACTS KNOWN BY THE BROKER THAT CONTRADICT ANY INFORMATION INCLUDED IN A WRITTEN INSPECTION REPORT ON THE PROPERTY OR REAL ESTATE THAT IS THE SUBJECT OF THE TRANSACTION.

32 TO ENSURE THAT THE BROKER IS AWARE OF WHAT SPECIFIC INFORMATION YOU CONSIDER CONFIDENTIAL, YOU MAY LIST THAT INFORMATION BELOW (SEE LINES 35-36). AT A LATER TIME, YOU MAY ALSO PROVIDE THE BROKER WITH OTHER INFORMATION YOU CONSIDER TO BE CONFIDENTIAL.

35 **CONFIDENTIAL INFORMATION:** \_\_\_\_\_

37 **NON-CONFIDENTIAL INFORMATION** (The following information may be disclosed by Broker): \_\_\_\_\_

39 (INSERT INFORMATION YOU AUTHORIZE THE BROKER TO DISCLOSE SUCH AS FINANCIAL QUALIFICATION INFORMATION.)

### CONSENT TO TELEPHONE SOLICITATION

41 I/We agree that the Broker and any affiliated settlement service providers (for example, a mortgage company or title company) may call our/my home or cell phone numbers regarding issues, goods and services related to the real estate transaction until I/we withdraw this consent in writing. **List Home/Cell Numbers:** \_\_\_\_\_

### SEX OFFENDER REGISTRY

45 Notice: You may obtain information about the sex offender registry and persons registered with the registry by contacting the Wisconsin Department of Corrections on the Internet at <http://offender.doc.state.wi.us/public/> or by phone at 608-240-5830.

### DEFINITION OF MATERIAL ADVERSE FACTS

48 A "material adverse fact" is defined in Wis. Stat. § 452.01 (5g) as an adverse fact that a party indicates is of such significance, or that is generally recognized by a competent licensee as being of such significance to a reasonable party, that it affects or would affect the party's decision to enter into a contract or agreement concerning a transaction or affects or would affect the party's decision about the terms of such a contract or agreement. An "adverse fact" is defined in Wis. Stat. § 452.01 (1e) as a condition or occurrence that a competent licensee generally recognizes will significantly and adversely affect the value of the property, significantly reduce the structural integrity of improvements to real estate, or present a significant health risk to occupants of the property; or information that indicates that a party to a transaction is not able to or does not intend to meet his or her obligations under a contract or agreement made concerning the transaction.