

For Sale

cresa

46,000 SF Fully Conditioned Warehouse/Flex Building

5964 Executive Drive, Fitchburg, WI 53719

Property Overview

| | |
|------------------------------|--|
| Property Type: | Flex/warehouse - Current use is indoor sports facility; however, the building is conducive for warehouse/flex requirements |
| Offering Price: | \$3,750,000 |
| Date of Construction: | 1996 |
| Building Size: | 45,661 SF: 41,386 SF (1st floor): 4,275 SF (Mezzanine) |
| Land/lot Size: | 120,120 SF (2.76 Acres) |
| Zoning: | B-G, General Business District |
| Parking Stalls: | 103 |
| Clear Height: | 24' |
| Loading: | 1 grade level door; dock positions can be added |
| Exterior Details: | Foundation: Poured Concrete / Asphalt & Gravel Frame: Steel Walls: Stucco / Metal Roof: Pitched metal roof |
| Interior Details: | Flooring: Tile / Carpet / Field Turf / Concrete Walls: Painted drywall / Exposed insulation / Painted block Ceiling: Suspended acoustical tile / Exposed insulation Lighting: Recessed incandescent / Fluorescent |
| HVAC: | Gas-fired forced-air furnaces with air conditioning throughout the building and independent de-humidification system |
| Other Features: | Fire & Life Safety: The building is fully sprinklered (NFPA 13) Mezzanine level with viewing gallery Parking Lot has recently been resurfaced |

For More Information:



Matt Apter
608.852.3001
mapter@cresa.com



Tim Ridders
608.669.4153
tridders@cresa.com

Cresa Madison
613 Williamson Street, 210
Madison WI 53703

Current Layout and Features

Building Breakdown: ~45,661 Sq. Ft.

MAIN FLOOR 41,386 (finished = 40,303)

| | |
|---|--------|
| Field area | 30,067 |
| A. Field Size (2fields x 80ft x 180ft) | |
| B. Bench area (9.42x134.5sqft= 1,267) | |
| Front area rooms (118 x 20sq') | 2,360 |
| C. Concessions, Offices, | |
| D. Lockers, Entry | |
| Spectator Area | 6,185 |
| E. Sides (180 x 10 = 3600) | |
| F. Front (approx. 2224.5sq') | |
| G. Miscellaneous - Goal to Side (accounted asphalt to side of goals) (3' x 30' x 4 = 360) | |
| Lease area | 1,691 |
| H. Chiropractic (approx 1,116sq.ft) | |
| H. MAYSA (approx 575sq.ft.) | |
| I. Storage Areas (approx. 775sq.ft) (Not incl beneath stairs) | 775 |
| Stair Footprint = | 308sq' |

UPSTAIRS 4,275 (finished = 2,919)

| | |
|--|--------|
| meeting & Office | 884 |
| J. Office -stairs: 145sq' | |
| J. Office middle: 163sq' | |
| J. Office - mtg: 144sq' | |
| K. Meeting: 432sq' | |
| viewing. | 2,035 |
| L. Main (12x135 = 1620sq') | |
| L. Cove (13 x24 = 312sq') | |
| L. Miscell (67 + 36= 103sq') | |
| Storage, | 1,092 |
| M. 13 x 48 = 642sq' | |
| M. Behind stairs: 30 x 15 = 450sq' | |
| N. Stairs Landings (SE= 4.5' X 18' = 81sq') (SW= 4x6=93) | 93sq.' |
| Mechanical (not assigned) 19 x 9 = | 171sq' |

All measurements are approximation

Did not use Measuring Sq.ft Practices/Standards:

<https://www.blankrome.com/index.cfm?contentID=37&itemID=3278>

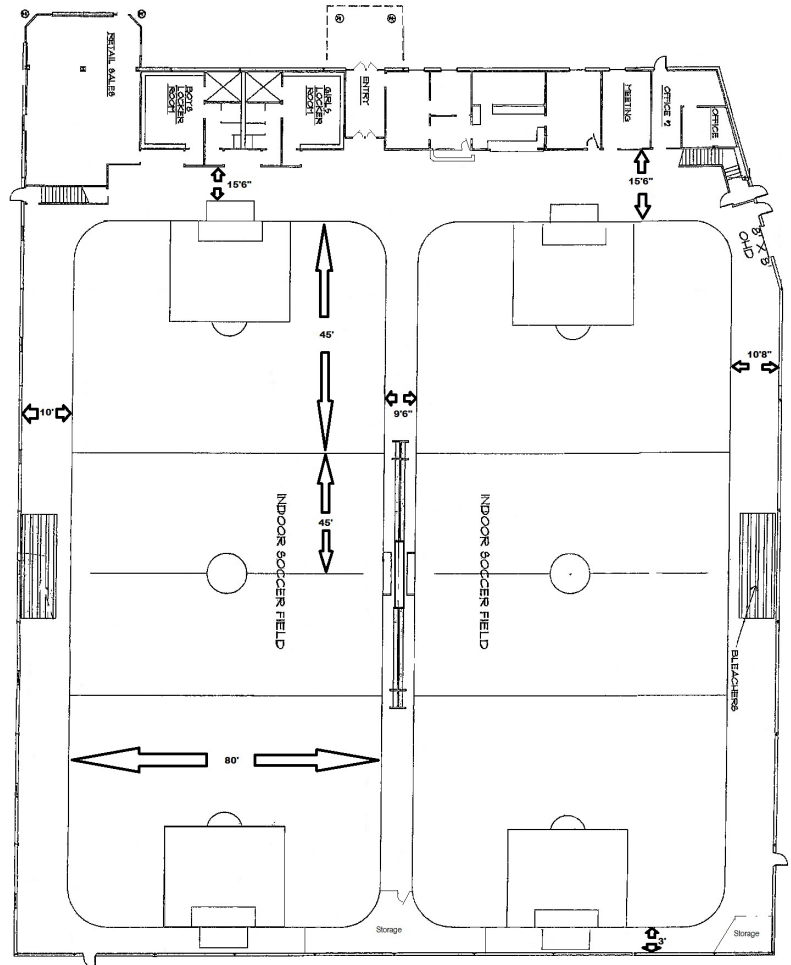

Cresa © 2019. All rights reserved. The information contained in this document has been obtained from sources believed reliable. While Cresa does not doubt its accuracy, Cresa has not verified it and makes no guarantee, warranty, or representation about it. It is your responsibility to independently confirm its accuracy and completeness. Any projections, opinions, assumptions or estimates used are for example only and do not represent the current or future performance of the property. The value of this transaction to you depends on tax and other factors which should be evaluated by your tax, financial and legal advisors. You and your advisors should conduct a careful, independent investigation of the property to determine to your satisfaction the suitability of the property for your needs.

Overview Map and Building Pictures

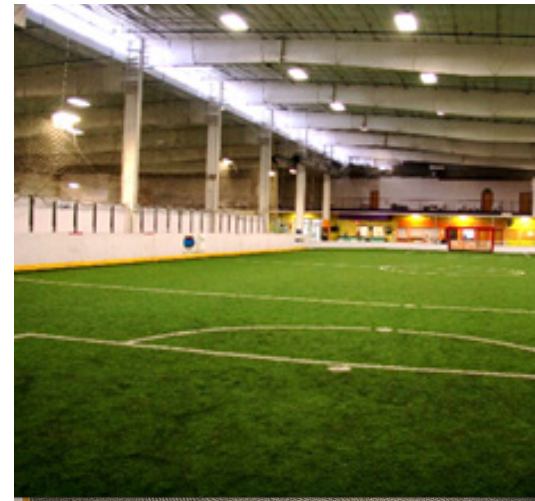

Cresa © 2019. All rights reserved. The information contained in this document has been obtained from sources believed reliable. While Cresa does not doubt its accuracy, Cresa has not verified it and makes no guarantee, warranty, or representation about it. It is your responsibility to independently confirm its accuracy and completeness. Any projections, opinions, assumptions or estimates used are for example only and do not represent the current or future performance of the property. The value of this transaction to you depends on tax and other factors which should be evaluated by your tax, financial and legal advisors. You and your advisors should conduct a careful, independent investigation of the property to determine to your satisfaction the suitability of the property for your needs.

Site Plan

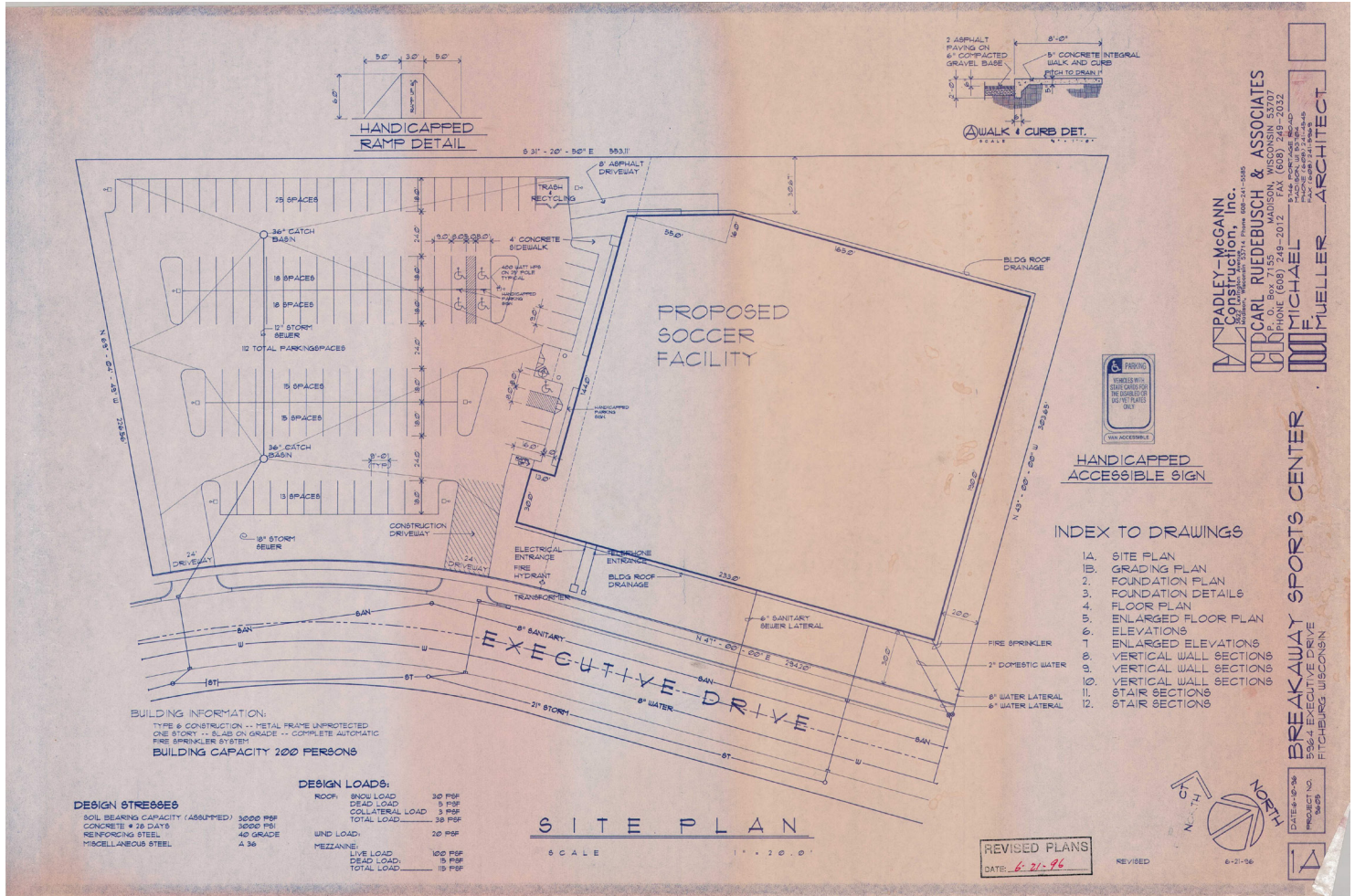

Cresa © 2019. All rights reserved. The information contained in this document has been obtained from sources believed reliable. While Cresa does not doubt its accuracy, Cresa has not verified it and makes no guarantee, warranty, or representation about it. It is your responsibility to independently confirm its accuracy and completeness. Any projections, opinions, assumptions or estimates used are for example only and do not represent the current or future performance of the property. The value of this transaction to you depends on tax and other factors which should be evaluated by your tax, financial and legal advisors. You and your advisors should conduct a careful, independent investigation of the property to determine to your satisfaction the suitability of the property for your needs.