

FOR SUB-LEASE

5520 Nobel Drive, Suite 100
Fitchburg WI 53711



Subleasing Information

Platypus Technologies has secured a long-term lease on the property and it seeks to sub-lease a portion of the available laboratory and office space.

Space Available for Sub-lease: Min: 1,200 sq. ft;
Max: 4,500 sq. ft.

Date Available : Flexible (August 1st at earliest).
Short-term (9 – 12 months) lease terms available.

Modified Gross Rent: \$25.00 per Square Foot Sub-Leased

Other: Proportional share fees for electricity, common area, cleaning, and maintenance.

Property Profile

- Located in Fitchburg Technology Campus
- Front-door parking
- Loading Dock
- 45-person Conference Room
- Breakroom with Vending
- Fitness Center
- Restrooms equipped with Showers
- On-site dry-cleaning pick-up/drop-off
- Outdoor patios
- Restaurants & Coffee shop nearby
- Bike path access

For More Information, Please Contact:

Marco A. Bedolla-Pantoja, PhD

Office: 608-237-1270 ext. 302

Email: mbedolla@platypustech.com

FOR SUB-LEASE

5520 Nobel Drive, Suite 100
Fitchburg WI 53711



PLATYPUS
TECHNOLOGIES

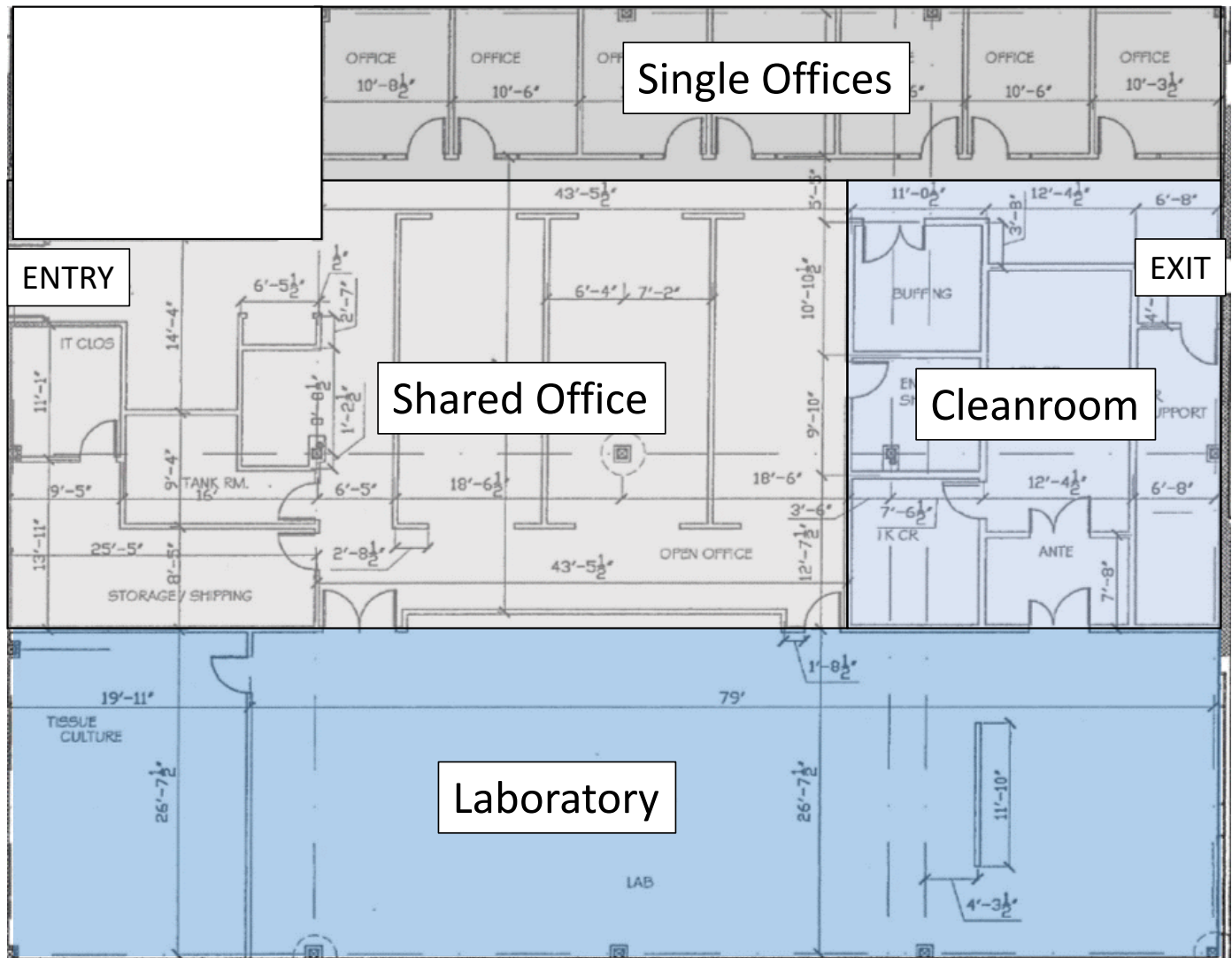

For More Information, Please Contact:

Marco A. Bedolla-Pantoja, PhD

Office: 608-237-1270 ext. 302

Email: mbedolla@platypustech.com

FOR SUB-LEASE

5520 Nobel Drive, Suite 100
Fitchburg WI 53711



PLATYPUS

TECHNOLOGIES

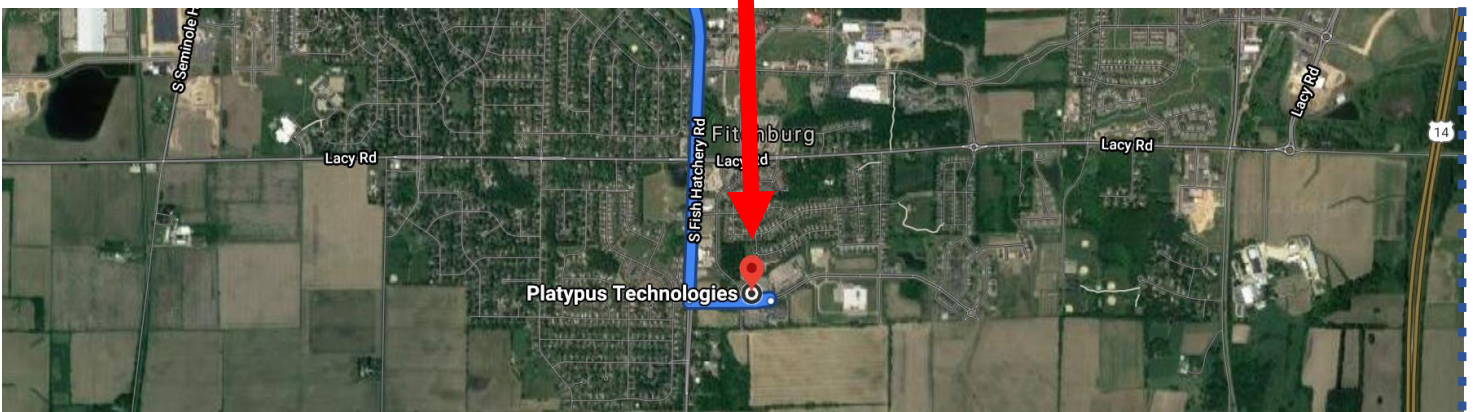
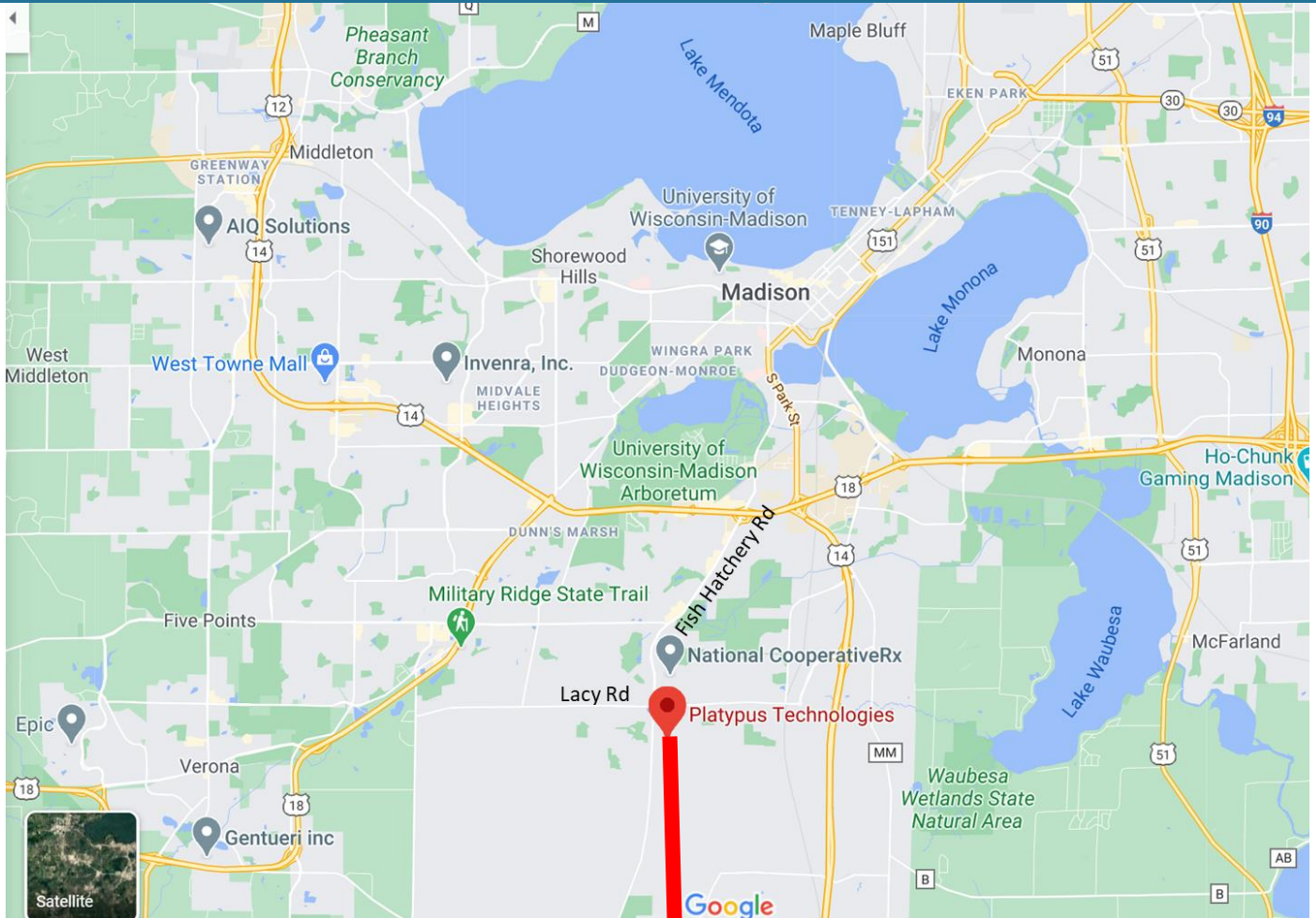

For More Information, Please Contact:

Marco A. Bedolla-Pantoja, PhD

Office: 608-237-1270 ext. 302

Email: mbedolla@platypustech.com

FOR SUB-LEASE

5520 Nobel Drive, Suite 100
Fitchburg WI 53711



PLATYPUS
TECHNOLOGIES

Additional Features:

- High Speed Wireless Internet
- Dedicated IT server room
- Furnished Private Offices
- Kitchenette
- Conference Room
- File cabinets
- Storage for laboratory supplies
- Shared Building Facilities (restrooms with showers, workout room (gym), autoclave, dishwasher and icemaker).

Laboratory Features:

- Chemical fume hoods
- Chemical cabinets
- Multiple laboratory sinks
- Dedicated gas tank room
- Liquid Nitrogen Dewar access
- Zeiss AxioPhot Fluorescent Microscope with automated stage
- Plate Reader
- Cell Incubator
- Cell Culture Hoods
- Eppendorf 548R Centrifuge
- Chemical Balances
- Refrigerator & Freezer
- Barnstead purified water

For More Information, Please Contact:

Marco A. Bedolla-Pantoja, PhD

Office: 608-237-1270 ext. 302

Email: mbedolla@platypustech.com

FOR SUB-LEASE

5520 Nobel Drive, Suite 100
Fitchburg WI 53711



PLATYPUS
TECHNOLOGIES

Main Laboratory



Cell Culture Laboratory



Shared Office

